



i wireless Center Building Information

1201 River Drive · Moline, Illinois 61265 · (309) 764-2001

www.iwirelesscenter.com

TABLE OF CONTENTS

ABOUT US

Building Contacts	1
What are the Quad Cities	2
How to get to the i wireless Center	2

TECHNICAL INFORMATION

Power, Staging, Barricade, Floor, Loading	3
Rigging, Parking, Floor Seats	4
Capacity, Phones, Guidelines	5
Security, Stage Labor, Runners	6
Catering, Dressing Rooms, Curfew	7
Labor Rates	8
Package Shipping, Sound/Light	9

FACILITY INFORMATION

Truck Parking, Loading Docks	10
Truck Parking Overflow	11
Dressing Rooms	12
Locker Rooms	13
Spot Light Locations	14
Generic Seating Diagram	15

LOCAL INFORMATION

Hotels	16
Hospitals	17
Auto Rental	18
Radio Stations	19

ENTERTAINMENT

Riverboat Casinos, Sports	20
Museums, Movie Theaters	21
Churches	22

BUILDING CONTACTS

(309) 764-2001

Executive Director	ext 309	Scott Mullen	smullen@iwirelesscenter.com
Assistant Executive Director	ext 310	Rocky Jones	rjones@iwirelesscenter.com
Director of Operations	ext 379	Kevin Snodgrass	ksnodgrass@iwirelesscenter.com
Senior Event Coordinator	ext 371	Elizabeth Dismer	edismer@iwirelesscenter.com
Director of Operations, Levy Restaurants	ext 322	Paul Bonney	pbonney@levyrestaurants.com
General Manager of Premium Services Levy Restaurants	ext 374	Deb Jacobsen	djacobsen@levyrestaurants.com
Engineering Supervisor	ext 338	Jake Hultman	jhultman@iwirelesscenter.com
Stage Manager	ext 359	Doug Stephenson	dstephenson@iwirelesscenter.com
Stage/Technical Manager	ext 372	Rob Ross	rross@iwirelesscenter.com
Box Office Manager	ext 366	Greg Mouw	gmouw@iwirelesscenter.com
Director of Marketing & Public Relations	ext 332	Stephani Nagle	snagle@iwirelesscenter.com

WHAT ARE THE QUAD CITIES?

1,500,000 people within a 60-mile radius. More than 400,000 people live in the Quad Cities which is made up of two Iowa and two Illinois cities that are economically and culturally interdependent. The four cities that line the Mississippi River are:

Rock Island, Illinois

Moline, Illinois

Davenport, Iowa

Bettendorf, Iowa

HOW TO GET TO THE I WIRELESS CENTER:

From Iowa:

Interstate 74 East (to Davenport/Bettendorf)

Cross the bridge into Illinois

Take the first Illinois Exit (River Drive)

Take a left on River Drive (at the stop light)

Travel 1/2 mile - the i wireless Center will be located on the right hand side of the street adjacent to the Radisson Hotel

From Illinois:

Interstate 74 West

Take the last Illinois Exit (7th Avenue)

Take a left on 7th Avenue (at the stop light)

Take a right on 19th Street (first stop light)

Take a left on River Drive (third stop light)

The i wireless Center is located just down the road on the right hand side

Just off of Interstate 74, the i wireless Center is easily accessible from either Illinois or Iowa. If you have further questions concerning directions to the i wireless Center contact the Administration Office at (309) 764-2001 or the Box Office at (309) 764-2000.

TECHNICAL INFORMATION

Power:

Stage Left	Stage Right
1-600A-120/208V	1-600A-120/208V
2-400A-120/208V	
Camlock input only	1-400A-120/208V
1-100A-120/208V	1-100A-120/208V

Shore Power 1-200A-120/208V Camlock input only.

All power is 100 feet from upstage center (on an end stage configuration). On center stage and theater setups are all power is 200 feet from upstage center.

Staging:

Stage Right
4' x 8' panels
4' - 6' heights available
1' - 3' per advance based on availability and limited size

Barricade:

Stage Right
Barricade - 80' (32' of blow thru available)
T-Barricade - 136' of concert crowd control blow thru barricade.

Ice Floor:

197' long x 85' wide
Portable Ice Floor. Header pipes run along the south side of rink.
Polar Floor ice covering.

Spotlights:

(8) Xenon Supertrouper

Loading Area:

2 loading docks with level access to arena floor (must fork to stage)
1 Elephant Door with 2 trailer capacity. Must ramp or fork to arena floor and fork to stage.

Distance from loading doors to end stage is 50'- 60'/Flat Push. Add 100 feet for mid stage.

RIGGING

Rigging Specs:

Rigging grid can support 120,000 lbs. of sound and lighting equipment over entire arena.
(This includes snow load.)

Major Beams:

Loads of 4,000 pounds must be spaced 4' apart on the major beams.
Major beams are on 31' centers.
Major beams run stage left to stage right.

Minor Beams:

Loads of 1,500 pounds must be spaced 4' apart on the minor beams.
Minor beams are on 15.5' centers.

Spreader Beams:

Spreader beams can support 500 pounds spaced 4' apart.

Beams over end stage also go Up and Downstage.
(Grid Pattern - 15'.5 centers)

Ground to low steel: 66.5' ice in and 67.5' ice out

Ground to high steel: 90.0'

NOTE - 110' Cherry picker needed - no safety cables for high steel -
Must be advanced with Senior Event Coordinator.

All beams are covered with safety retardant which will need to be knocked off during load-in.

Rigging obstructions:

Video wall on West end stages. Video wall protrudes 10' from West wall with the first beam (a minor) 4' downstage of the video wall.

PARKING

5 bus spaces marked outside of elephant door on West end of building. 18 wheel tractor trailers can park in 2 dock bays which are stage left. Five possible trucks can park in bay. For load-in/out the wireless Center can unload/load 4 trucks at once with the use of the Elephant Door. Additional spaces for 18-wheelers are located on west side of building along the river.

FLOOR SEATS

If end stage configuration, sections D, E, and F will be set prior to load-in unless other arrangements are made. Sections A, B, and C will be set only with permission from the production manager, promoter or building manager. This must start no later than 4 hours prior to doors opening.

CAPACITIES

End stage:

11,500 capacity (based on 60 X 40 stage)

Center stage:

12,000 capacity (based on 40 X 40 stage with no ice floor]

Basketball:

10,700 capacity / 31,000 Square feet (with no ice floor)

Hockey:

9,800 capacity / 31,000 Square feet (ice floor is 198 X 85)

Arena Football::

9,460 capacity / 31,000 Square feet (with no ice floor)

TELEPHONES

All lines are "dial 9"

23 in-house lines available

*For pricing see rate card in contract

Advancing is done with Senior Event Coordinator.

Broadband internet service is available. Internet service arrangements should be advanced with the Senior Event Coordinator prior to DOS.

VIDEO WALL AND RIBBON BOARD

The video wall is 720x480 ntsc standard resolution. Most formats are accepted, but uncompressed avi files or dv compressed avis are preferred.

The ribbon board is 6304px wide by 24px tall and accepts uncompressed avi files at 30fps or still bitmap (.bmp) images.

HOUSE GUIDELINES

Please do not tape to any doors or walls. Bulletin boards have been placed for your convenience next to Dressing Rooms and Production Offices.

All Promoters/Production Managers to be available for a morning and aftershow walk-thru to inspect all production areas for damage. An inspection form to be signed after each walk-thru.

No unauthorized guests may be in backstage area without proper show credentials. This includes spouses, friends, wives, children, etc.

No one under 18 years of age is permitted in the backstage dressing room area. Show passes issued by the production staff are to adhere to the 18 and over policy of the Facility.

The i wireless Center is a non-smoking facility.

SECURITY

Security arrangements to be made with the Senior Event Coordinator.

POLICE ESCORTS

Police escorts, merchandise police, uniformed officers, and undercover officers are contracted through the i wireless Center. All police personnel arrangements are to be made with the Senior Event Coordinator. Police are on a 2-hour minimum. Arrangements with less than 48 hours notice cannot be guaranteed.

STAGE LABOR MINIMUMS

Load-in/Load-out: 4 hour minimum

Show Call: 4 hour minimum

*Overtime "time-and-a-half" after 8 hours

**Holiday pay is time-and-a-half

RUNNERS/CATERING ASSISTANTS

Must be advanced with Senior Event Coordinator: \$200 per day.

Pre-Shop: \$100.00

CATERING

Levy Restaurants
(309) 764-2001, ext. 374 (Catering Manager)
(In house contract ONLY) No outside food or beverage permitted.

MERCHANDISING

Contracted to Levy Restaurants
(309) 764-2001, ext. 322 (Merchandise Contact)
(In house contract)

DRESSING ROOMS

- 1 VIP Room with no shower or restroom
- 2 Dressing Rooms with shower and restroom
- 1 Large Star Room with shower and restroom
- 3 Team rooms with showers and restrooms
- 3 Production Offices no shower or restroom

FURNITURE

None in-house. Rental arrangements to be made with Senior Event Coordinator. Limited house pipe and drape available per advance.

CURFEW

Curfew ordinances are enforced throughout the Quad Cities.

In Illinois, persons under 17 years of age must be off the streets by 11:00pm Sunday-Thursday and by midnight Friday-Saturday unless accompanied by a parent.

In Iowa, persons under 18 years of age must be off the streets by 11:00 p.m. Sunday-Thursday and by midnight Friday-Saturday.

In most cases there is leeway-- if a person can prove they are on a direct route home after a late movie, for example, they may not get in trouble. (Quad City Times; Sept. 16, 1994)

LABOR RATES

Event Sup.	\$18.50
Usher/Ticket Seller	\$14.00
Security/Parking Guard	\$15.75
Usher/Parking/Sec. Sup.	\$17.00
Police/Medic	\$60.00
Maint./Engineer/Grounds	\$14.00
Turnover Crew (3rd Shift)	\$14.50
Camera Op.	\$25.50
House Lights/Tech.	\$25.00
Stagehand	\$23.50
Truck Loader	\$23.50
Wardrobe	\$23.50
Fork Operator	\$24.50
High Rigger	\$40.00
Ground Rigger	\$25.50
Steward	\$30.00
Department Head	\$24.50
Head Rigger	\$41.00
Stage Electrician	\$36.00
Clean-up (Full-house)	\$3,100.00
Clean-up (1/2 house/lower)	\$1,900.00
Extra Clean-up (Dirt show)	\$1,200.00

All equipment:

- is subject to availability.
- prices are each, per day, unless otherwise indicated.
- rates subject to change without notice.

All labor:

- Rates are per person, per hour, with a 2-hour minimum unless otherwise noted.
- Rates subject to change without notice. (Current as of February 2013-February 2014)

PACKAGE SHIPPING

Pak Mail (ship anything - anywhere)

4022 Blackhawk Rd.
Rock Island, Illinois 61201
(309) 786-5845

UPS (Des Moines)

1-800-942-7127

Federal Express

1-800-238-5355

LOCAL SOUND & LIGHTING COMPANIES:

River Cities Sound and Lights Inc.

1025 W. 4th St.
Davenport, Iowa 52804
(563) 323-7398

RAK Productions Sound & Lighting

4184 Illinois Highway 81
Lynn Center, IL 61262
(309) 476-8375

TRUCK PARKING, LOADING DOCKS

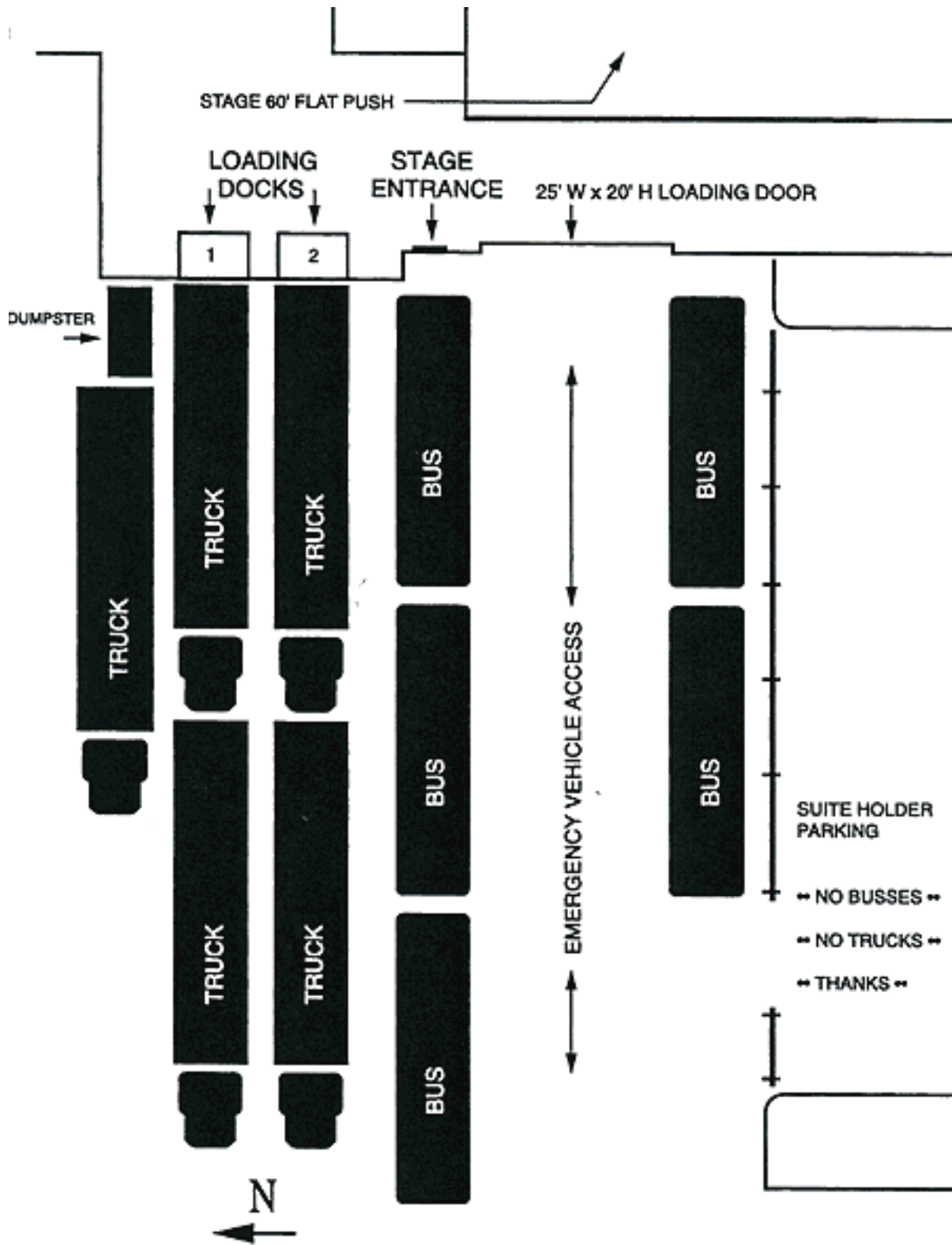

TRUCK PARKING - OVERFLOW



DRESSING ROOMS

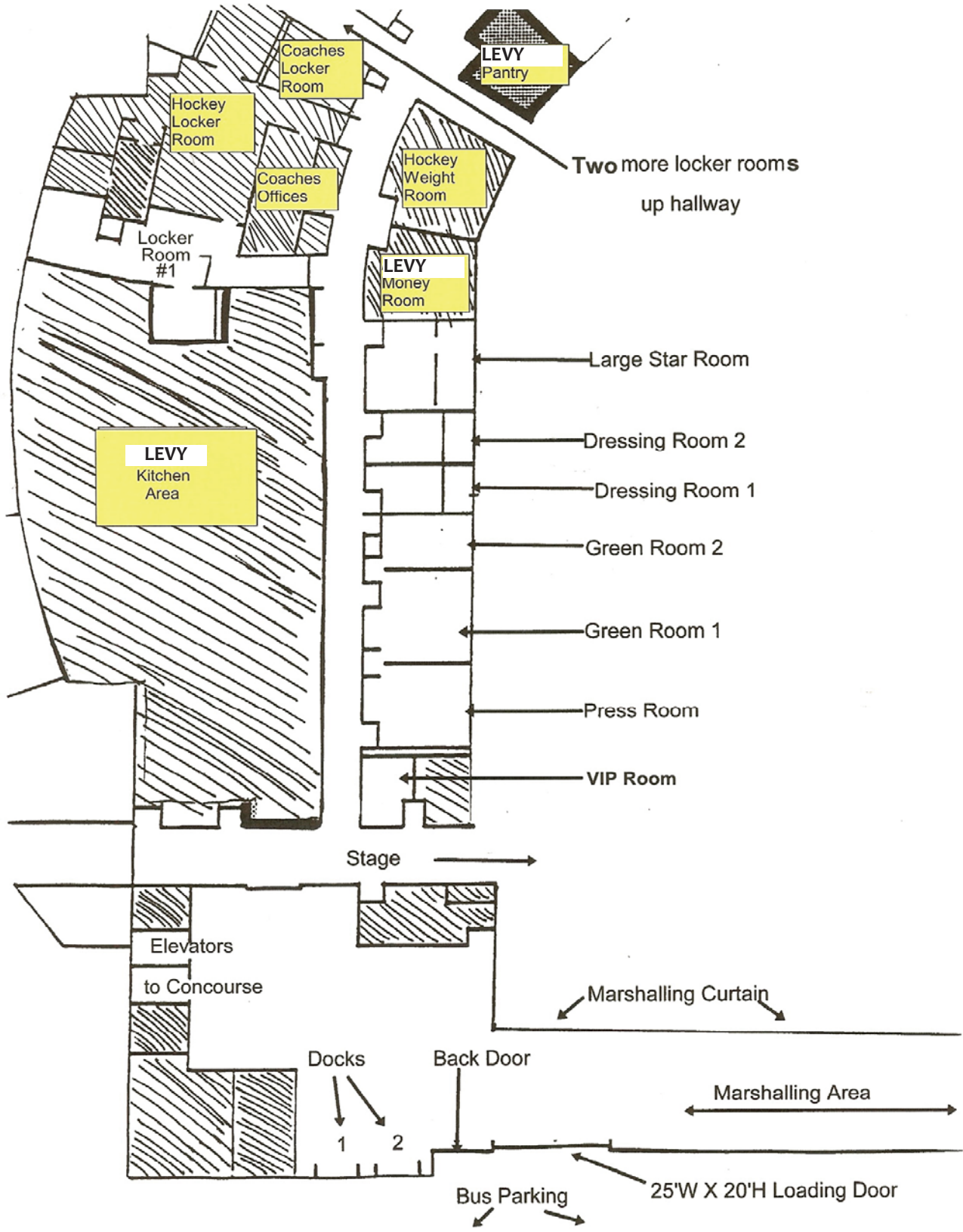

Production Hall.max

LOCKER ROOMS

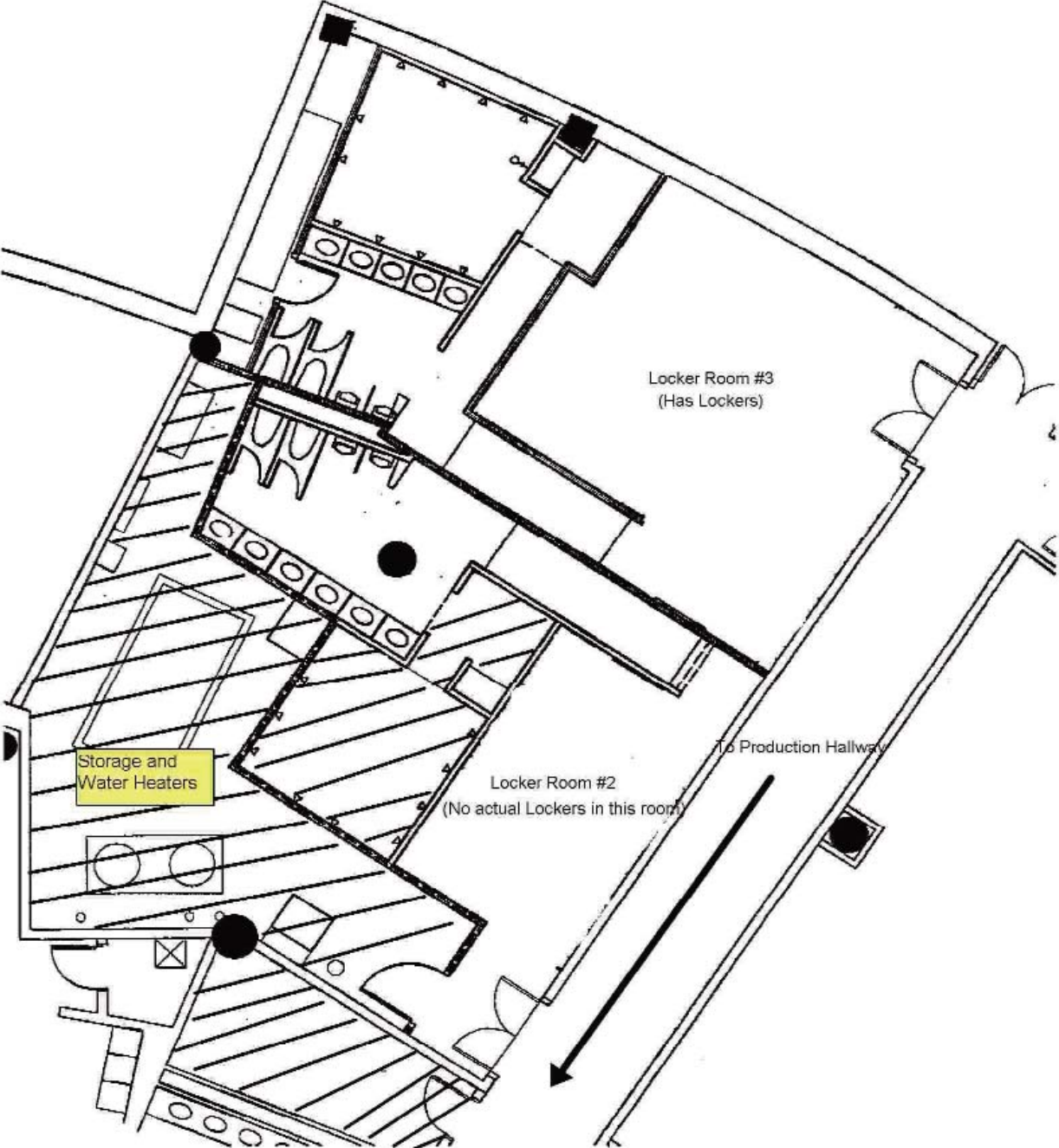

Old Hockey Locker Rooms.max

SPOTLIGHT LOCATIONS

WEIGHT CAPS	
—	Major: 4,000lbs/4ft.
- - -	Minor: 1,500lbs/4ft.
.....	Spreader: 500lbs/12ft.
Total Grid - 120,000 lbs	
Low Steel Height - 67 ft.	

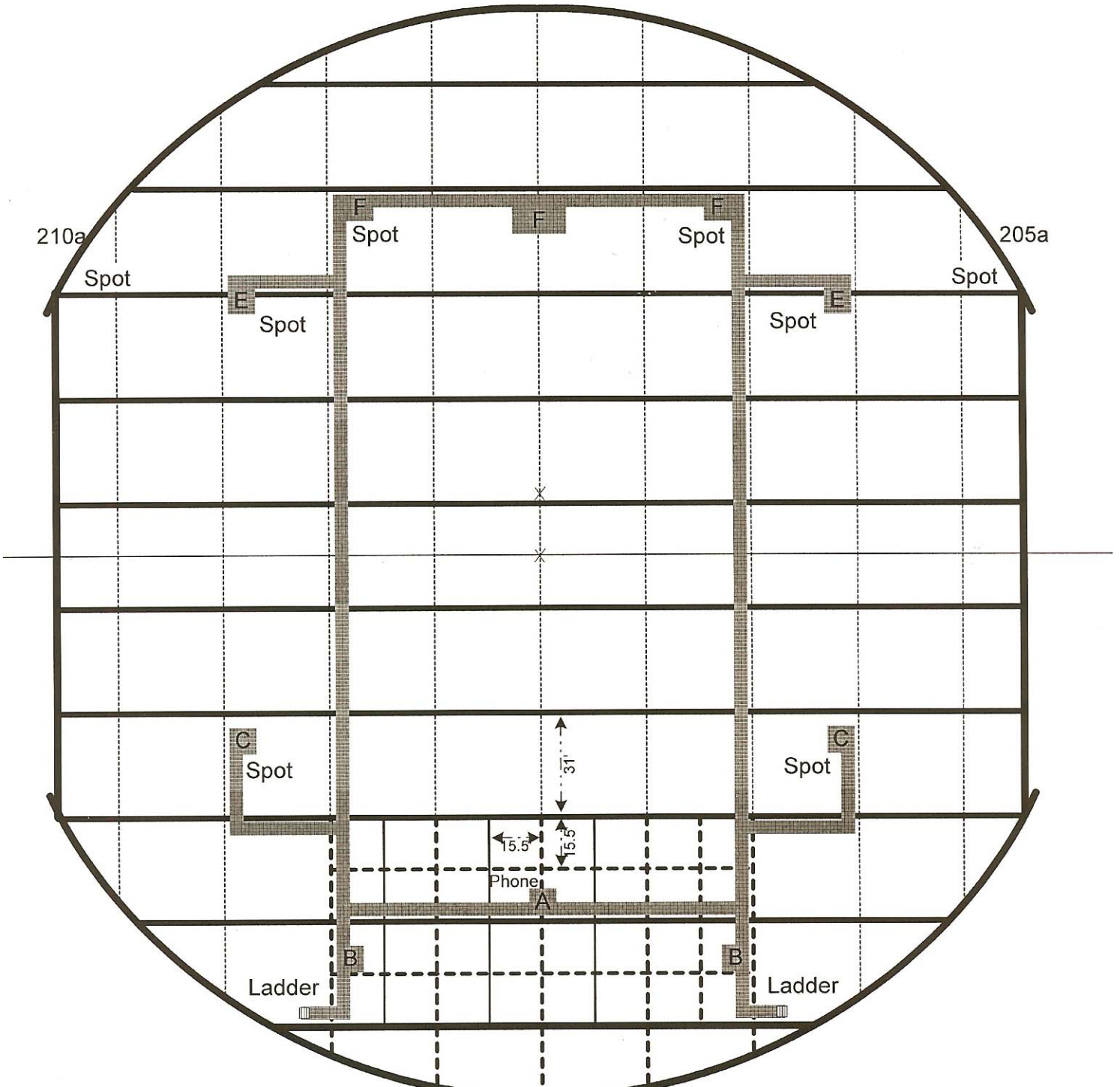

GENERIC SEATING DIAGRAM

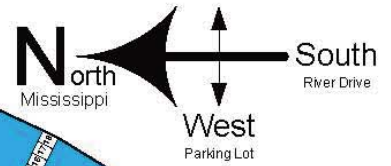
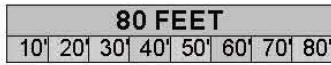

40' Depth	180	220	360	48' Depth	180	220	360
Floor	1,892	1,892	1,892	Floor	1,760	1,760	1,760
Lower	3,927	4,161	4,257	Lower	3,781	3,975	4,257
Upper	4,816	5,061	5,141	Upper	4,636	4,881	5,141
	10,635	11,114	11,290		10,177	10,616	11,158

Capacities are net of estimated kills
 GA Floor Capacity is up to 2100 depending on production footprints



HOTELS

Radisson on John Deere Commons

1415 River Drive
Moline, IL 61265
309-764-1000
(approximately 1 minute from the i wireless Center)

Stoney Creek Inn

101 18th Street
Moline, IL 61265
309-743-0101
(approximately 2 minutes from the i wireless Center)

Isle Casino & Hotel

1800 Isle Parkway
Bettendorf, IA 52722
1-800-724-5825
(approximately 15 minutes from the i wireless Center)

Jumer's Casino & Hotel

777 Jumer Dr.
Rock Island, IL 61204
(309) 756-4600
(approximately 15 minutes from the i wireless Center)

Radisson Quad City Plaza Hotel

111 East Second Street
Davenport, IA 52801
563-322-2200
(approximately 15 minutes from the i wireless Center)

The Lodge

Spruce Hills Drive and Utica Ridge Road
Bettendorf, IA 52722
563-359-7141
(approximately 15 minutes from the i wireless Center)

HomeRidge Inn & Suites

909 Middle Road
Bettendorf, IA 52732
800-626-0780
(approximately 10 minutes from the i wireless Center)

Holiday Inn, Rock Island

Third Avenue & 17th Street
Rock Island, IL 61201-8723
(approximately 15 minutes from the i wireless Center)

Comfort Inn & Suites, Davenport

8300 Northwest Blvd
Davenport, IA 52806
563-324-8300
(approximately 15 minutes from the i wireless Center)

Econo Lodge

815 Golden Valley Dr
Bettendorf, IA 52722
563-355-6336
(approximately 7 minutes from the i wireless Center)

Hotel Blackhawk

200 East 3rd St
Davenport, IA 52801
563-322-5000
(approximately 12 minutes from the i wireless Center)

HOSPITALS

Genesis Medical Center

West Campus
West Central Park Avenue
Davenport, Iowa
(563) 421-1440
(approximately 20 minutes from the i wireless Center)

Genesis Medical Center

East Campus
1227 E. Rusholme St.
Davenport, Iowa
(563) 421-1000
(approximately 20 minutes from the i wireless Center)

Trinity Medical Center

500 John Deere Road
Moline, Illinois
(309) 779-5000
(approximately 15 minutes from the i wireless Center)

Trinity Medical Center - North Campus

1111 W. Kimberly Road
Davenport, Iowa
(563) 391-8949
(approximately 20 minutes from the i wireless Center)

Trinity Medical Center - West Campus

2701 17th Street
Rock Island, IL 61201
(309) 793-2121

Trinity at Terrace Park

4500 Utica Ridge Road
Bettendorf, IA 52722
(563) 742-5000
(approximately 10 minutes from the i wireless Center)

Genesis Medical Center-Illini Campus

801 Hospital Road
Silvis, Illinois
(309) 792-9363
(approximately 20 minutes from the i wireless Center)

AUTO RENTAL

ACT II Transportation, Inc.

504 W 1st Ave
Coal Valley, IL 61240
309-799-8891

Enterprise Rent-A-Car

3401 16th Street
Moline, IL 61265
309-736-1000

Reynolds Motor Company

1900 Avenue of the Cities
East Moline, IL 61244
309-792-9530

MVP Collision

101 E. 1st Avenue
Milan, IL 61264
(309) 787-5600

Quad City International Airports

National: 309-764-4696
Hertz: 309-762-9429
Avis: 309-762-3605

Vehicles/Vans:

Contact Senior Event Coordinator for more information about van and vehicle rentals.

RADIO STATIONS

FM

KALA 85.5/105.5	Jazz/Gospel/Urban
WVIK 90.3	Public radio, classic
KQCS 93.5	Adult Contemporary
KMXG 96.1	Adult Contemporary
WXLP 96.9	Classic Rock
WLKU 98.9	Contemporary/Christian
KBEA 99.7	Top 40
KUNI 102.1	News/Talk /NPR
WLLR 103.7	Country
KISS 101.3	Top 40 CHR
KBOB 104.9	Active Rock
KCQQ 106.5	Classic Rock

AM

KJOC 1170	Sports/Talk radio
WFXN 1230	Sports/Talk radio
WOC 1420	News/Talk radio

RIVERBOAT CASINOS

Isle Casino & Hotel (5 minute drive)
1821 State Street, Bettendorf, IA
1-800-724-5825

Rhythm City Casino (10 minute drive)
130 West River Drive, Davenport, IA
(563) 322-2628

Jumer's Casino & Hotel (15 minute drive)
777 Jumer Drive, Rock Island, IL
(309) 756-4600

SPORTS

Indian Bluff Golf Course (18 holes, moderate)
6200 78th Avenue, Milan, IL
(309) 799-3868

Palmer Hills Golf Course (18 holes, difficult)
2999 Middle Road, Bettendorf, IA
(563) 332-8296

TPC at Deere Run (18 holes, difficult)
3100 Heather Knoll, Silvis, IL
(309) 796-6000

Sundown Ski Resort
16991 Asbury, Dubuque, IA
(563) 556-6676
1 1/2 hours from Moline

Quad Cities River Bandits (Single A) Baseball
Modern Woodmen Park
209 South Gaines Street
Davenport, IA
(563) 3BANDIT

Arrangements may be made to utilize a private, local, 65 acre farm featuring indoor horse riding, outdoor shooting range, motorsports & hunting. Inquire with the Senior Event Coordinator for more information.

MUSEUMS, TOURS AND FAMILY ENTERTAINMENT

The John Deere Pavilion

1300 River Drive
(309) 765-1007

Niabi Zoo (250 + animals)

12908 Niabi Zoo Road, Coal Valley, IL
(309) 799-3482

Putnam Museum (Science and Natural History) IMAX theater

1737 West 12th St., Davenport, IA
(563) 326-7804

Family Museum

2900 Learning Campus Drive, Bettendorf, IA
(563) 344-4106

River Music Experience

129 Main Street, Davenport, IA
(563) 326-1333

Figge Art Museum

225 West 2nd Street, Davenport, IA
(563) 326-7804

MOVIE THEATERS

RAVE Theaters

3601 E. 53rd St., Davenport, IA
(563) 441-0200

Nova 6

2000 36th Ave, Moline, IL
(309) 797-1863

Moline Great Escape

4100 38th Street, Moline, IL
(309) 794-1863

CHURCHES

St. Mary's (Catholic)
412 10th St., Moline, IL
(309) 764-1562

Our Lady of Lourdes (Catholic)
415 15th St., Bettendorf, IA
(563) 359-0345

Community Christian Church (Christian)
4330 12th Ave., Moline, IL
(309) 764-7274

Central Baptist Church
1901 12th St., Moline, IL
(309) 762-0650

Grace Lutheran Church
1140 E. High Street, Davenport, IA
(563) 322-0769

First Christian Church-Disciples of Christ
510 E. 15th St., Davenport, IA
(563) 322-0929

Evangelical Church (non-denominational)
2812 Sheridan, Davenport, IA
(563) 326-4839

Temple Emanuel (Jewish)
12th & Mississippi Streets, Davenport, IA
(563) 326-4419

For other denominations not listed here, please contact Event Coordinator for information.