

Production Guide

Prudential Center–Newark, NJ



Table of Contents

- Introduction..... page 3
- Key Contacts..... page 5
- Location & Transportation..... page 6
- Seating Specifications page 10
- Center Hung & Led Specifications page 15
- Dressing Rooms & Production Space..... page 16
- Hospitality page 18
- Catering Information..... page 19
- Technical..... page 20
- Load-In Information..... page 25
- Information Technology page 26
- Additional Services..... page 27

About Prudential Center

Prudential Center is a world-class sports and entertainment venue located in downtown Newark, New Jersey. Opened in October 2007, the state-of-the-art arena is the home of the National Hockey League's (NHL) three-time Stanley Cup Champion New Jersey Devils, Seton Hall University's NCAA Division I Men's Basketball program, and more than 175 concerts, family shows and special events each year. Ranked in the Top 10 nationally by Pollstar, Billboard and Venues Now, Prudential Center is recognized as one of the premier venues in the United States, and welcomes 1.75 million guests annually. For more information about Prudential Center, visit PruCenter.com and Facebook, and follow **@PruCenter** on **Twitter** and **Instagram**.

All files in this document may also be found at www.prucenter.com/production

username: **pruproduction**

password: **pruproduction**

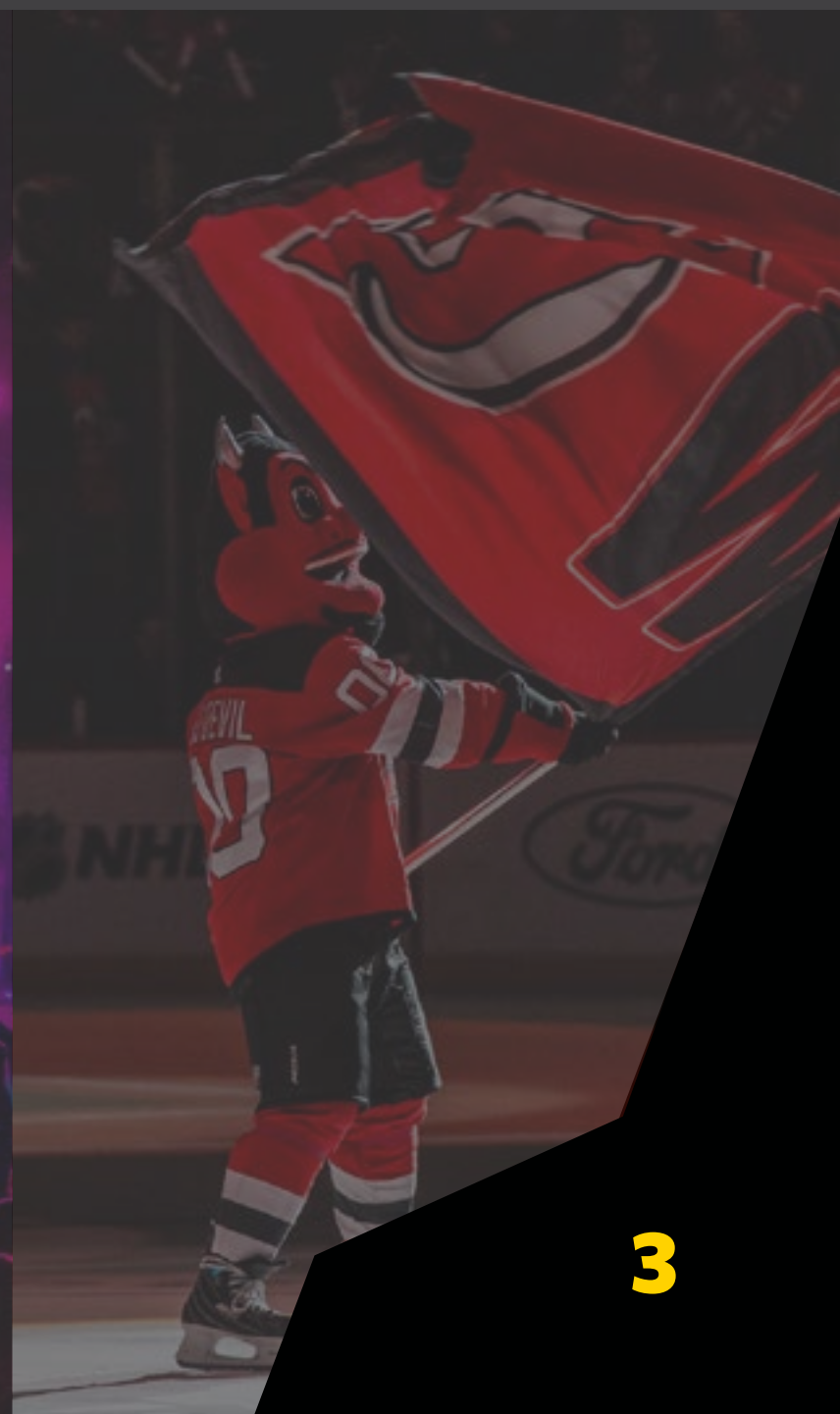



Welcome to Newark, New Jersey and thank you for choosing the Prudential Center for your next event! As New Jersey's premier sports and entertainment destination and one of the top-ten ranked venues in North America, we pride ourselves on offering a best-in-class experience for all our clients, musical acts, NHL teams, sponsors, partners, and fans.

Here at "The Rock," there is something truly special about this building and our team members. When you walk our concourse during a New Jersey Devils game, family show or concert, there are always so many smiling faces. Those smiling faces come from the engagement of our Guest Services team members and the enjoyment of our attendees. We are confident that when you walk our hallways and enter the event space, you will find out why our people love working here, and are sure that you will smile too.

On behalf of our entire Prudential Center team, thank you and we look forward to working with you on putting forth an incredible entertainment experience!

Steve Rosebrook

Executive Vice President, Prudential Center General Manager

Sean Saadeh

Executive Vice President, Entertainment



Key Contacts

Entertainment

Name	Title	Email	Office	Mobile
Sean Saadeh	EVP, Entertainment	SSaadeh@prucenter.com	(973) 757-6511	(201) 937-9771
Dylan Wanagiel	VP, Sports Properties & Special Events	DWanagiel@prucenter.com	(973) 757-6577	(917) 572-8823
Tyler Bates	VP, Entertainment Booking	TBates@prucenter.com	(973) 757-6519	N/A
Matthew Ackerman	Director, Entertainment Marketing	MAckerman@prucenter.com	(973) 757-6219	N/A
Shannon D'Amore	Associate Manager, Booking and Special Events	SDamore@prucenter.com	(973) 757-6252	(973) 856-4914

Event Operations

Name	Title	Email	Office	Mobile
Stephen Rosebrook	General Manager, Prudential Center	StephenRosebrook@prucenter.com	(973) 757-6508	N/A
Joe Altenau	VP, Event Operations & Guest Experience	JAltenau@prucenter.com	(973) 757-6608	(914) 384-5500
Jamie Marino	Director, Event Operations	JMarino@prucenter.com	(973) 757-6553	(908) 581-0267
Kevin Stark	Manager, Event Operations	kevinstark@prucenter.com	(973) 757-6584	(563) 563-1579
Zach Hrinuk	Assistant Manager, Event Operations	zachhrinuk@prucenter.com	(973) 757-6527	(973) 715-5933
Taylor Marcine	Assistant Manager, Event Operations	taylormarcine@prucenter.com	(973) 757-6590	(973) 803-8673

Ticket Operations

Name	Title	Email	Office	Mobile
Rick Katz	Director, Ticket Operations	RKatz@prucenter.com	(973) 757-6622	N/A
Al Kass	Box Office Consultant	AKass@prucenter.com	N/A	N/A
Pat Shark	Sr. Coordinator, Ticket Operations	PShark@prucenter.com	(973) 757-6228	N/A

Public Relations

Name	Title	Email	Office	Mobile
Lara Toscani	Corporate Communications	LaraToscani@HBSE.com	N/A	(610) 675-8153

Welcome to New Jersey

Prudential Center is located within a 5-minute walk to 4 major hotels with over 650 guest rooms, and less than 5 miles to 11 major hotels offering an additional 2,900+ guest rooms.

From Newark Liberty International Airport

Follow signs for Route 1&9 North and follow directions for Garden State Parkway North.

From New York City

From George Washington Bridge or Lincoln Tunnel, follow signs to New Jersey Turnpike South. Follow directions for New Jersey Turnpike.

From New Jersey Turnpike South

Take Exit 15E (Newark/Jersey City), follow signs to Raymond Boulevard. At the stop light, turn right and proceed about 2 miles to Mulberry Street. Turn left onto Mulberry Street. Continue past Market Street and Edison Place. Prudential Center is on the right.

From Garden State Parkway South

Take Exit 145 and follow signs to Route 280 East (Harrison/Newark). Take Exit 15 (Route 21/Downtown Newark). Turn right and drive ½ mile on Route 21. Turn right at the intersection onto Market Street. Turn left at the next light onto Mulberry Street. Prudential Center is on the right.

From Garden State Parkway North/Rt.78

Take Exit 142 (Route 78). Follow Route 78 East to Exit 58A, following signs for Route 1&9 North. Proceed to Route 21 North (McCarter Highway). Continue north on Route 21 for approximately 1.5 miles. Turn left at the intersection onto Market Street. Turn left at the next light onto Mulberry Street. Prudential Center is on the right.

By Path & NJ Transit

Upon arrival in Newark Penn Station, proceed to the main station. Look for signs that say "Platform H". This will lead to the Gateway Bridge/Gateway Center. This is an above ground tunnel that leaves off about a block away from Prudential Center. Follow the Gateway all the way through – you will pass a New York Sports Club, Dunkin' Donuts, etc. Take the escalator downstairs to exit the building. Make a left out of the building and Prudential Center is a block away.

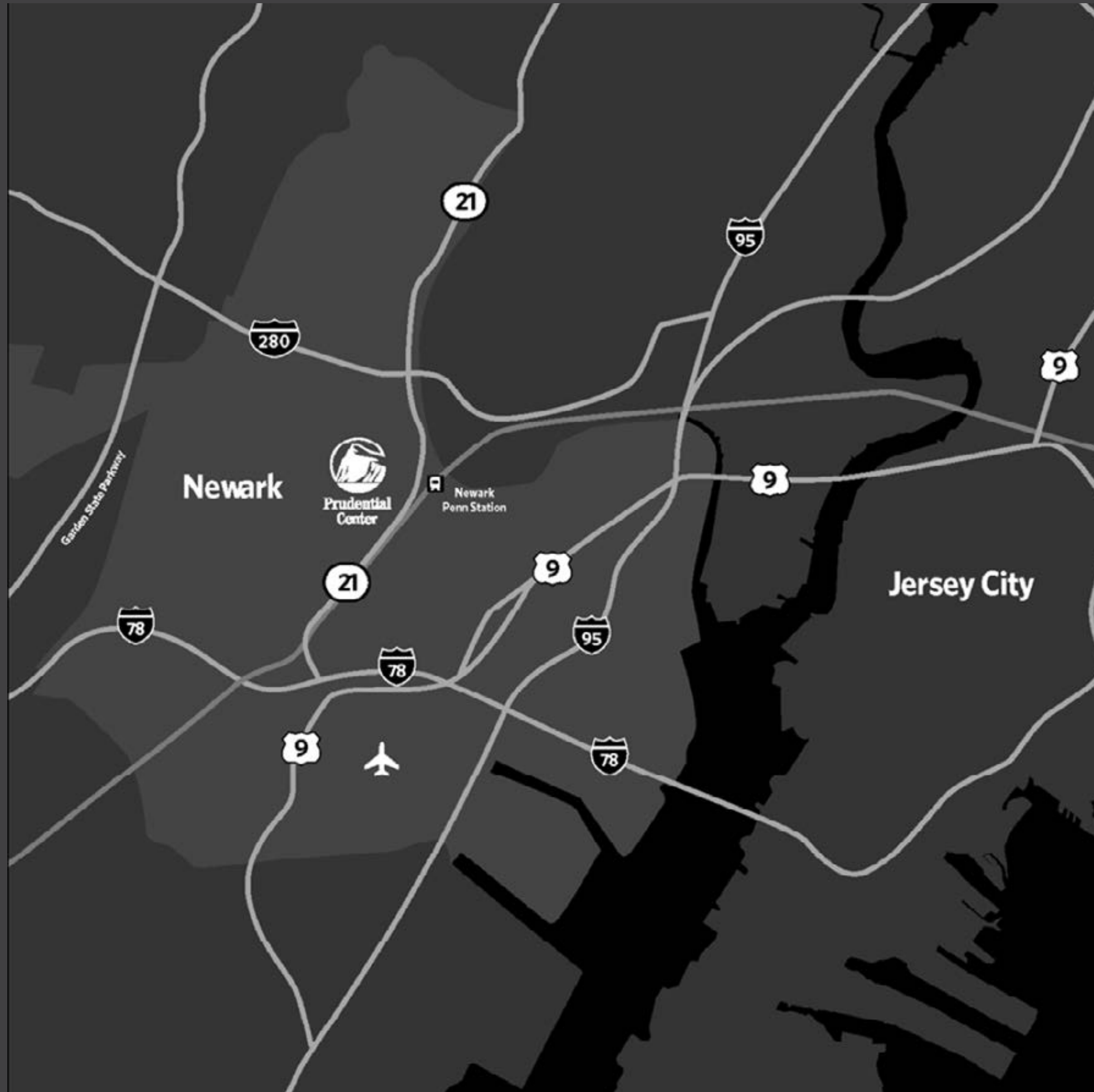

Parking Map

Available Parking Surrounding Prudential Center

Company	Map key	Address	Capacities (approximate)	Indoor/Outdoor
Parking Deck presented by Ford	10	15 Lafayette Street	250 spaces	Indoor
J & L Parking Green 5	5	232 Mulberry St.	225 spaces	Outdoor
LA Parking Green 6	6	970 Mulberry St.	70 spaces	Outdoor
Edison ParkFast	9	386 Market St.	185 stacked spaces	Outdoor
LAZ Gateway Lot: Yellow 2	2	Mulberry St. & Market St.	620 spaces	Indoor
Icon Parking	11	111 Mulberry St.	100 stacked spaces	Indoor/Outdoor
LAZ Parking	12	91-103 Mulberry St.	85 stacked spaces	Outdoor
J & L Parking Yellow 13	13	Mulberry St. & Green St.	300 spaces	Outdoor
Welcome Parking LLC	14	42-48 Clinton St.	250 spaces	Indoor
744 Parking LLC	15	16-18 Clinton St.	60 stacked spaces	Outdoor
Edison ParkFast	16	17-21 Clinton St.	60 stacked spaces	Outdoor
Star Parking	18	23 Edison Place	45 to 60 spaces	Outdoor
J & L Parking Green 3 & 4	3/4	Lafayette & Mulberry St.	700 spaces	Outdoor
LA ParkingGreen 7 & 8	7/8	Mulberry St & Kinney Street.	800 spaces	Outdoor
Edison ParkFast	9a	81 Edison Place,	600 spaces	Outdoor
Green Street	17	47-63 Green Street	515 spaces	Indoor

Lots subject to availability

All parking is subject to pricing determined by lot owners

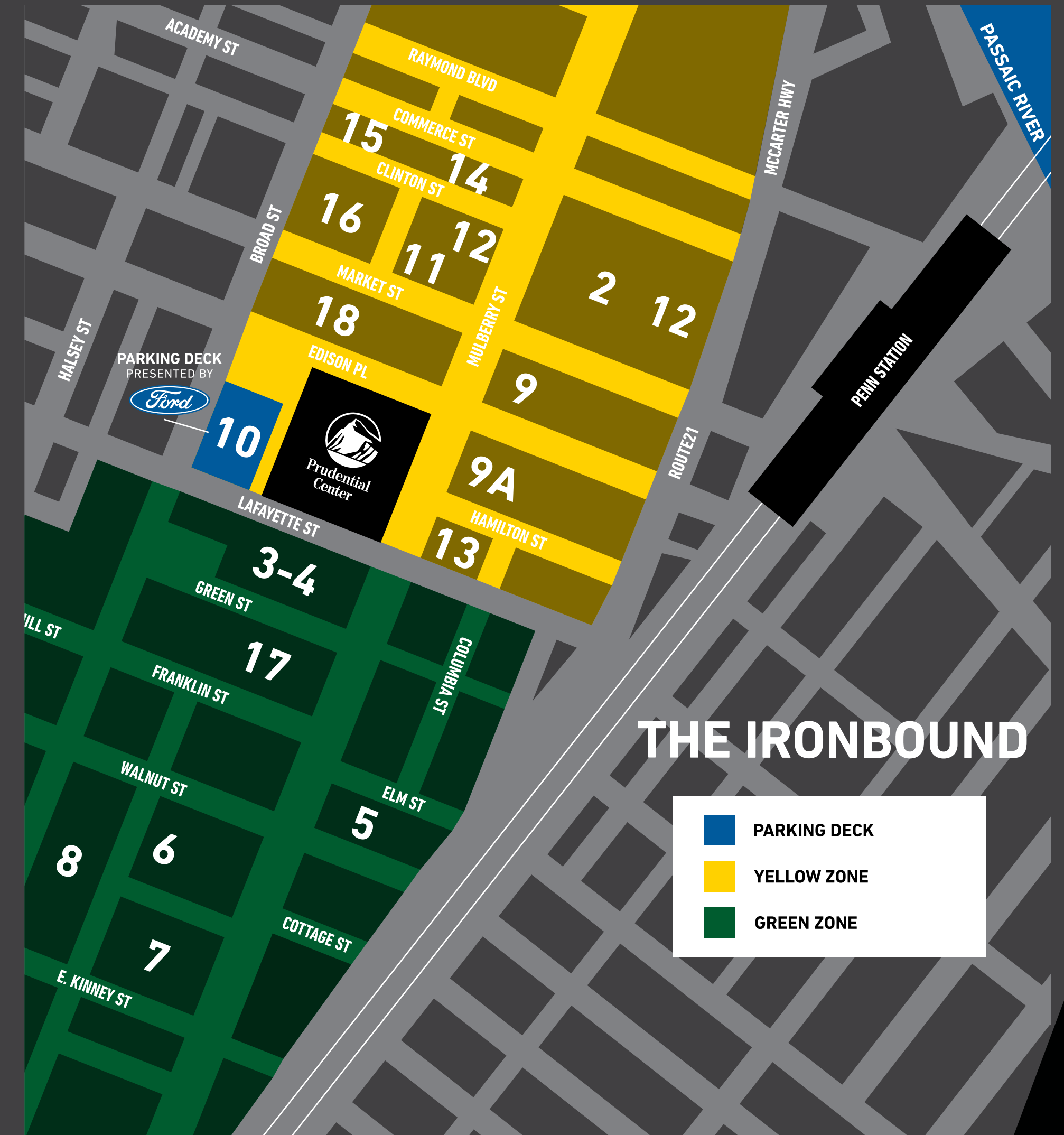

Arena Car & Trucking

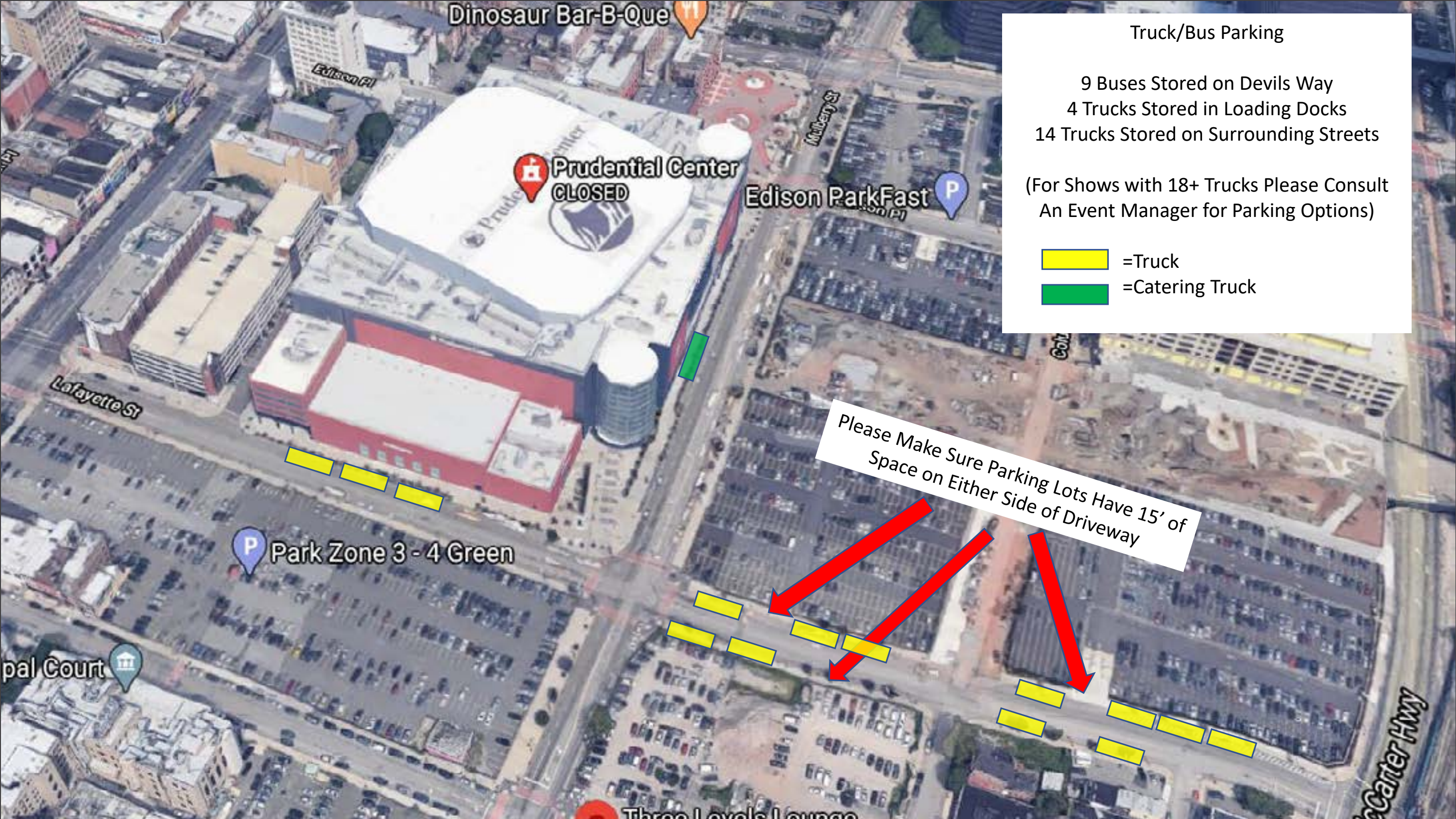

Trucks may park in the areas highlighted in yellow.
*Please note the 20 spots located in the backstage area are not available from **6:00AM-3:00PM** on Thursdays and Sundays.

Backstage Parking on Devils Way

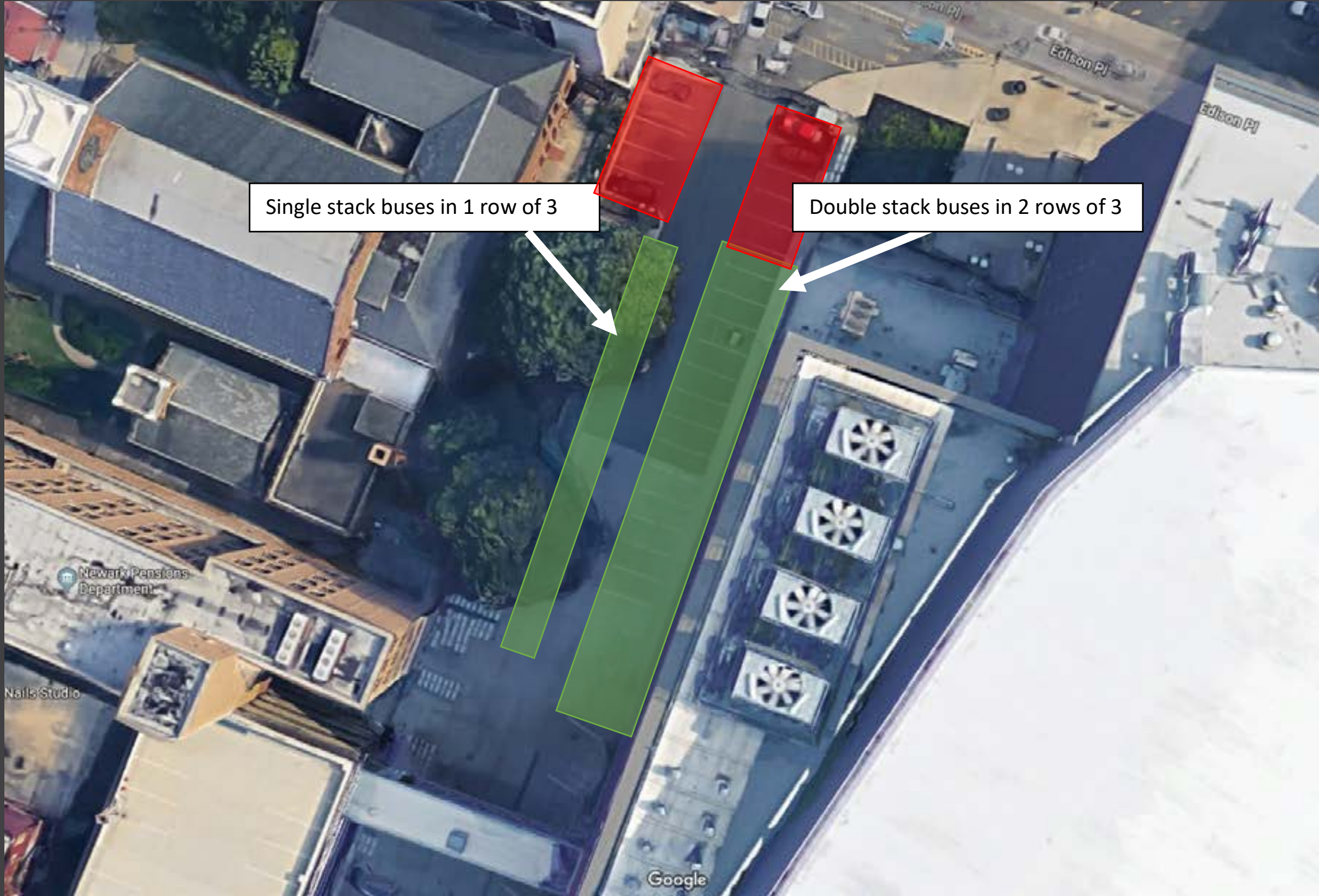

Areas in green are available spaces to park. Areas in red are not available .

Seating Chart Specifications

End Stage - 180 Degrees

Floor: **1,722**

Lower: **5,122**

100 Level: **3,173**

200 Level: **2,154**

Total: **12,425**

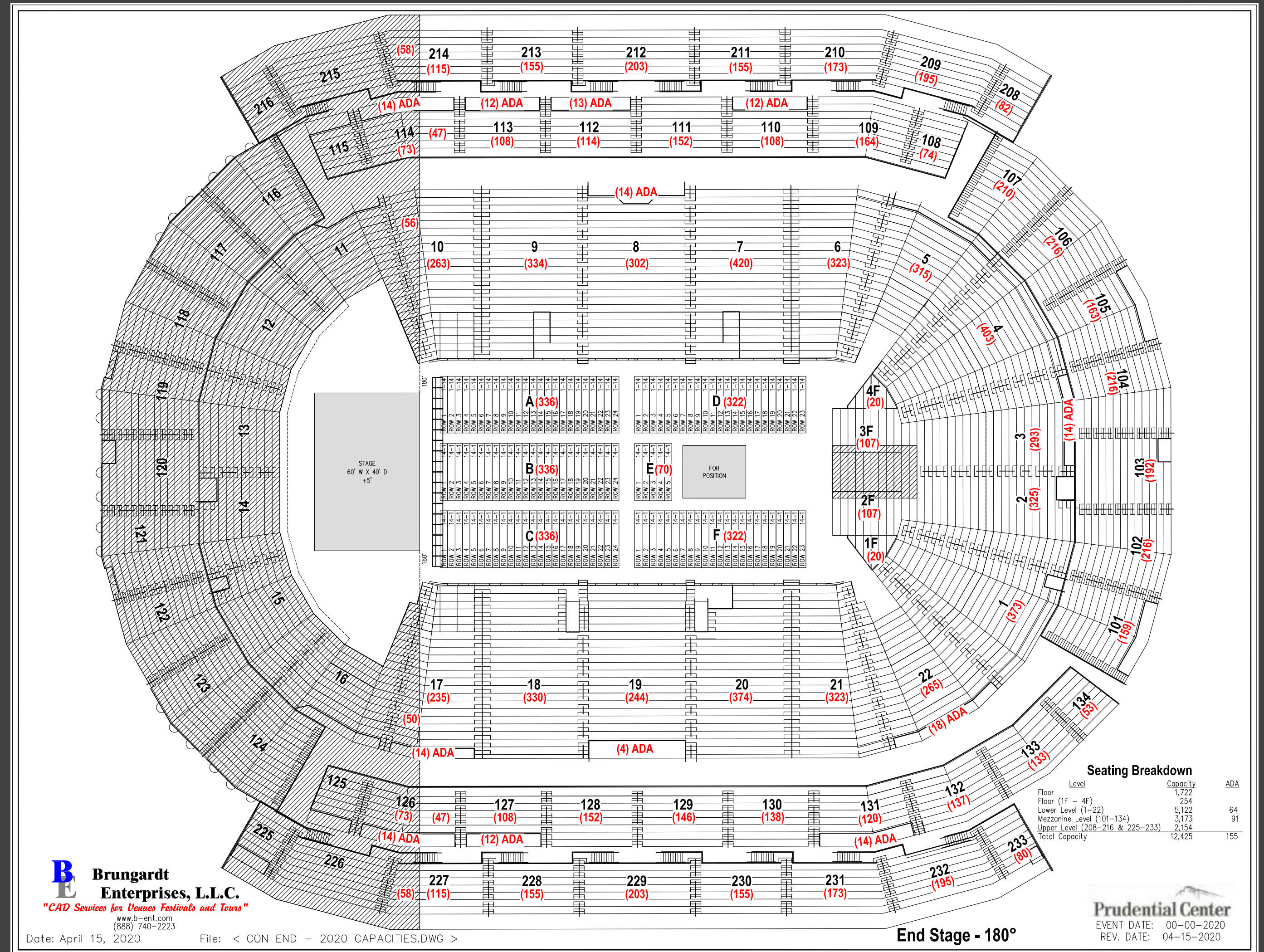

Seating Chart Specifications

End Stage - 220 Degrees

Floor: **1,722**

Lower: **5,488**

100 Level: **3,426**

200 Level: **2,659**

Total: **13,549**

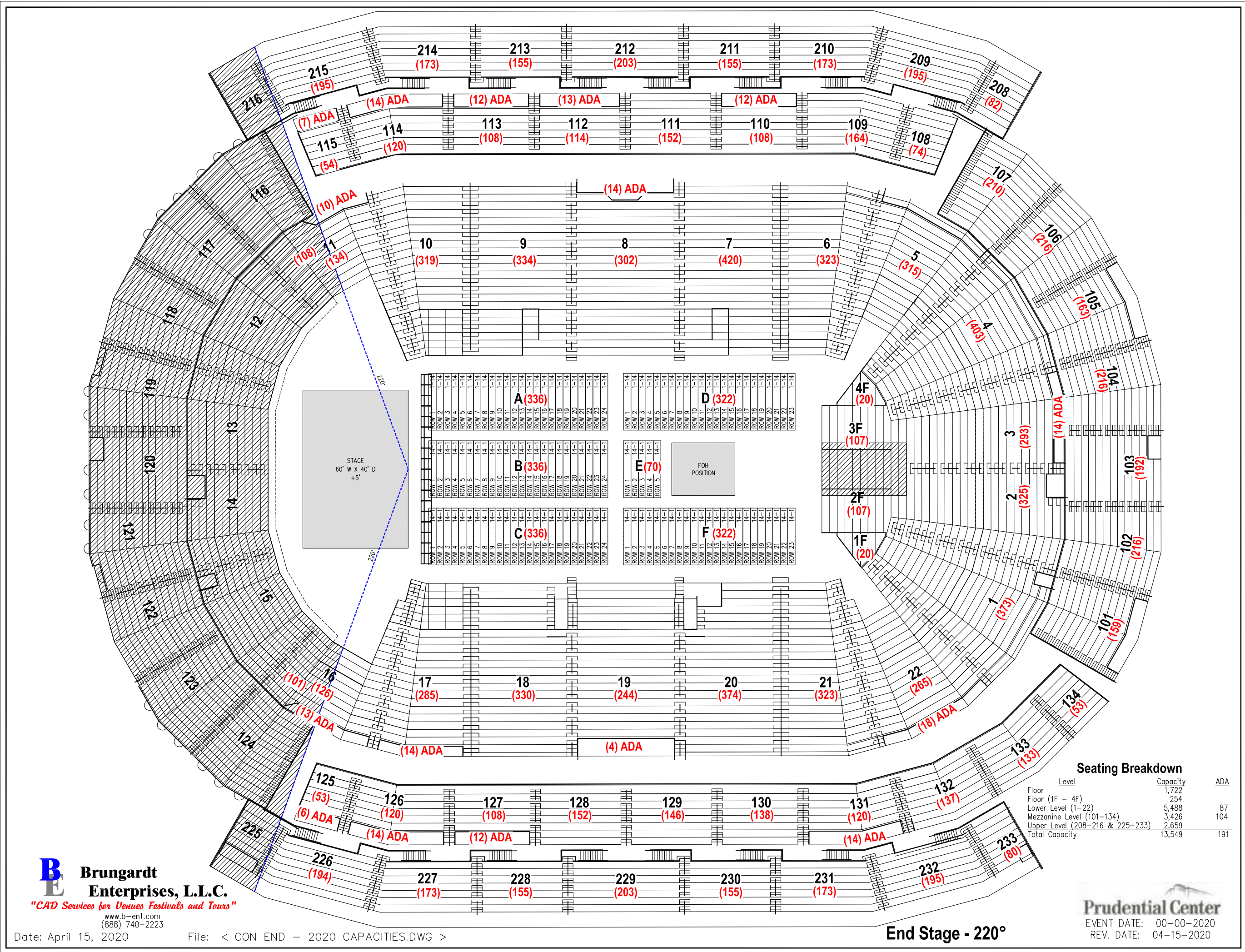

Brungardt Enterprises, L.L.C.
"CAD Services for Venues, Festivals and Tours"
www.b-ent.com
(888) 740-2223

Date: April 15, 2020 File: < CON END - 2020 CAPACITIES.DWG >

Seating Chart Specifications

End Stage - 240 Degrees

Floor: **1,722**

Lower: **5,666**

100 Level: **3,636**

200 Level: **2,820**

Total: **14,098**

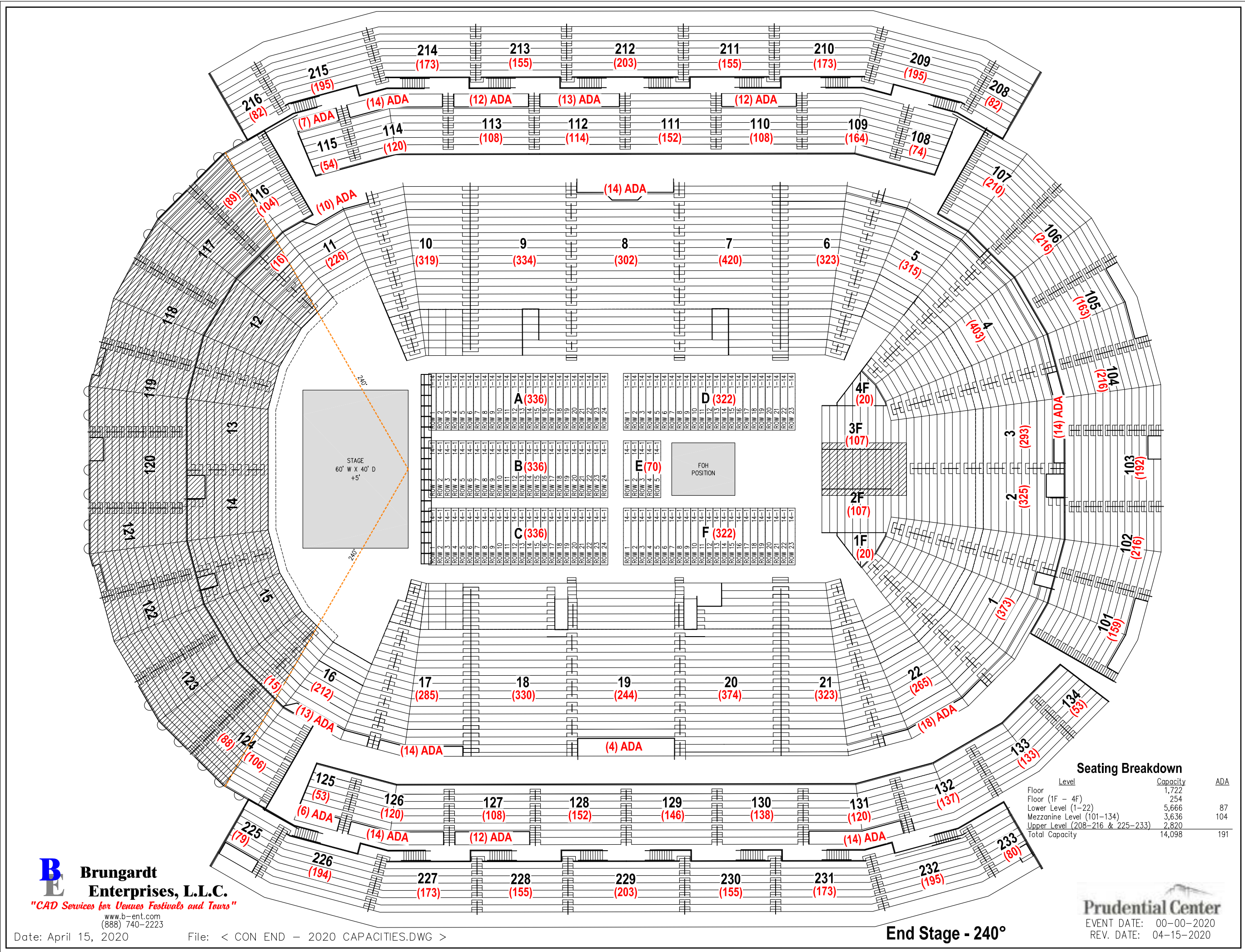

Seating Chart Specifications

End Stage - 270 Degrees

Floor: **1,722**

Lower: **5,916**

100 Level: **4,036**

200 Level: **2,820**

Total: **14,748**

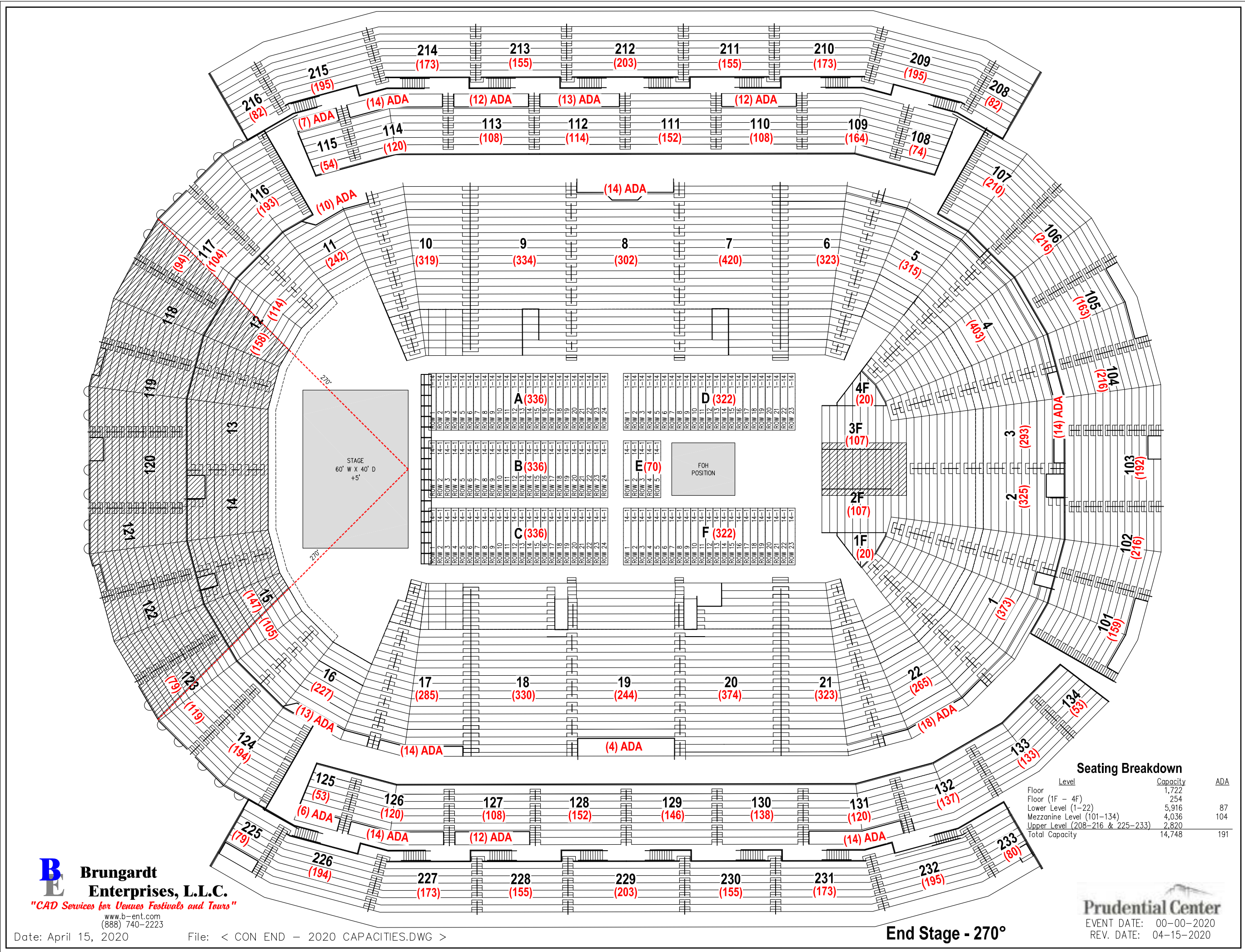

Brungardt Enterprises, L.L.C.
"CAD Services for Venues, Festivals and Tours"
www.b-ent.com
(888) 740-2223

Date: April 15, 2020 File: < CON END - 2020 CAPACITIES.DWG >

Seating Chart Specifications

End Stage - 360 Degrees

Floor: **1,722**

Lower: **6,630**

100 Level: **5,208**

200 Level: **2,820**

Total: **16,632**

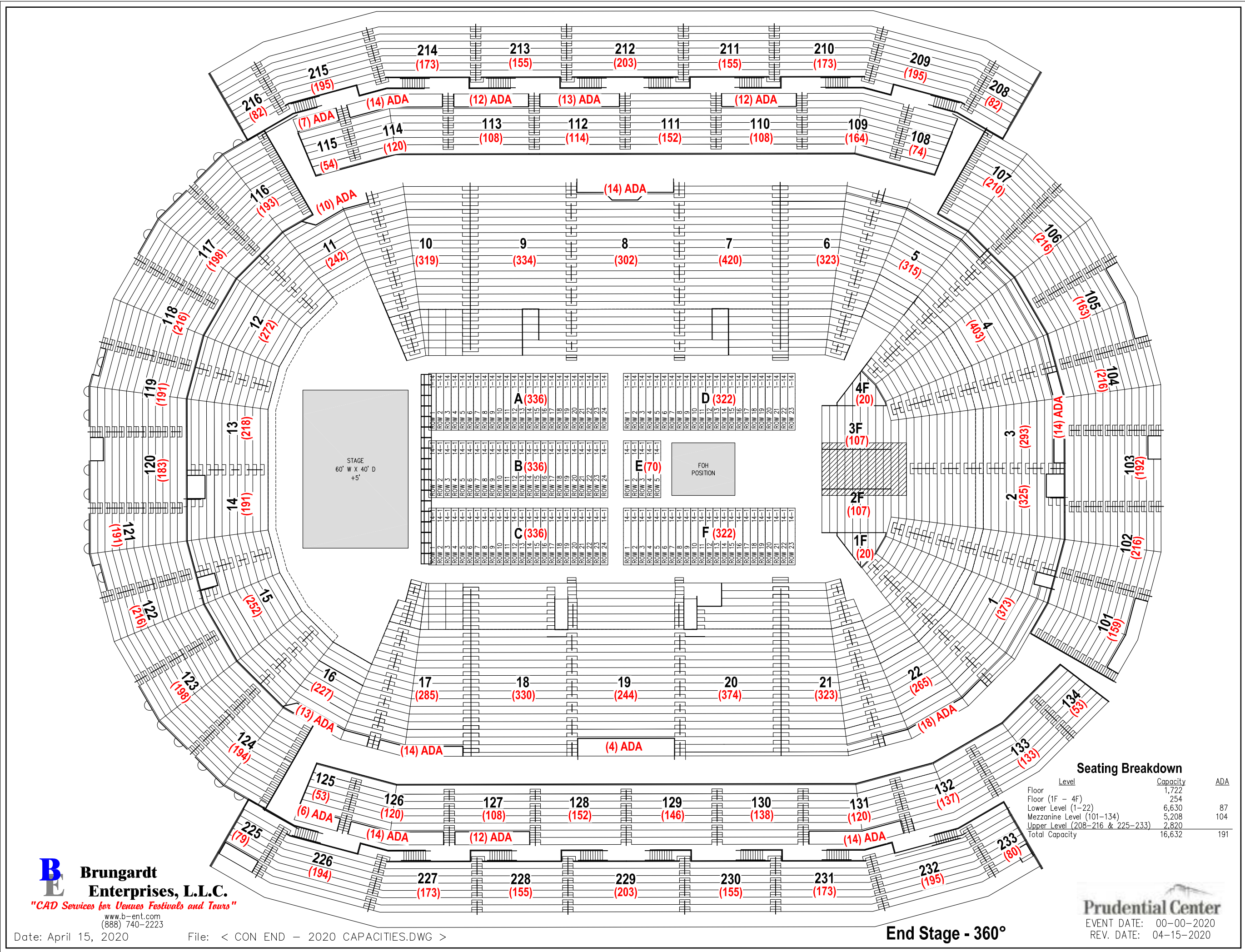

Rock Vision

Specifications

Main Board ("A") 1920 x 1080 Ross Xpression - Video	Lower 360 Ribbon ("F") 28,576 x 64 Blaze #1	Half Wedge (Gameplay) 504x 1416 Blaze #3 and #4	Penalty Box Vom Signage 224 x 112 (448 x 112 FULL) Blaze #6	Belly Board 1 & 3 1,200 x 720 Blaze #1, Output #2	AMN 768 x 1360 DAK KVM—AMN	Stanchion Arm (Basket LED) 240 x 120 Blaze #6
Bottom Corner ("B") 576 x 648 Blaze #3 and #4	Lower 360 Ribbon ("G") 27,808 x 64 Blaze #2	Zamboni Vom Signage 784 x 112 Blaze #6	Lower Barge ("E") 1792 x 386 (1792 x 504 FULL) Blaze #5	Belly Board 2 & 4 1,200 x 720 Blaze #1, Output #2	Scorer's Table (center court) 4320 x 180 Blaze #6	Scoreboard Window ("F") 1200 x 64 Blaze #1
Lower Ribbon ("D") 1792 x 118 Blaze #5	Full Wedge (Pre-Game) 504x 2016 Blaze #3 and #4	Bench Vom Signage 280 x 112 (560 x 112 FULL) Blaze #6	Upper Wedge ("C") 504 x 600 Blaze #3 and #4	Marquee 1472 x 752 DAK KVM—Marquee	Baseline Table (island board) 720 X 180 Blaze #6	OOT/Events/CC/Hustle 742 x 64 Blaze #1

Video Specifications

Animation Codecs

Uncompressed AVI @ 30 Frames Per Second

Uncompressed Animation Codec MOV @ 30 Frames Per Second

Uncompressed MOV with Alpha Channel @ 30 Frames Per Second

Size

The size of your file will be exact pixel size of your LED boards

Audio

No Audio

Physical Specs

Board is 60'x60'

"Barge" located under scoreboard can retract inside main board

Board trims at 70' when fully retracted



Technical

Dressing Rooms / Auxiliary Locker Rooms

All star dressing rooms, locker rooms and production spaces are stage left.

Star Dressing Rooms (4)

- Each includes bathroom, shower facilities, teledata connection Internet jacks, flat panel TVs and wireless internet.
- Each pair of star dressing rooms includes connecting doors to create two larger spaces.
- Star Dressing Room 1- 320 sq. ft. - 16' x 20'
- Star Dressing Room 2- 340 sq. ft. - 17' x 20'
- Star Dressing Room 3- 160 sq. ft. - 24' x 12'
- Star Dressing Room 4- 219 sq. ft. - 24' x 12'

Auxiliary Locker Rooms (4)

- Auxiliary Locker Room 1- 614 sq. ft. - 16' x 36'
- Auxiliary Locker Room 2- 462 sq. ft. - 16' x 16'
- Auxiliary Locker Room 3- 622 sq. ft. - 20' x 16'
 - Office NHL Massage- 139 sq. ft. - 10' x 14'
- Auxiliary Locker Room 4- 526 sq. ft. - 24' x 20'
- NHL Visiting Team LR 19'x15' (visiting team locker room subject to availability)
- NHL Visiting Team Changing Room 13'x17'
 - Office/Treatment- 295' sq. ft. - 10' x 30'
- SHU Locker Room- 484 sq. ft. - 22' x 22'

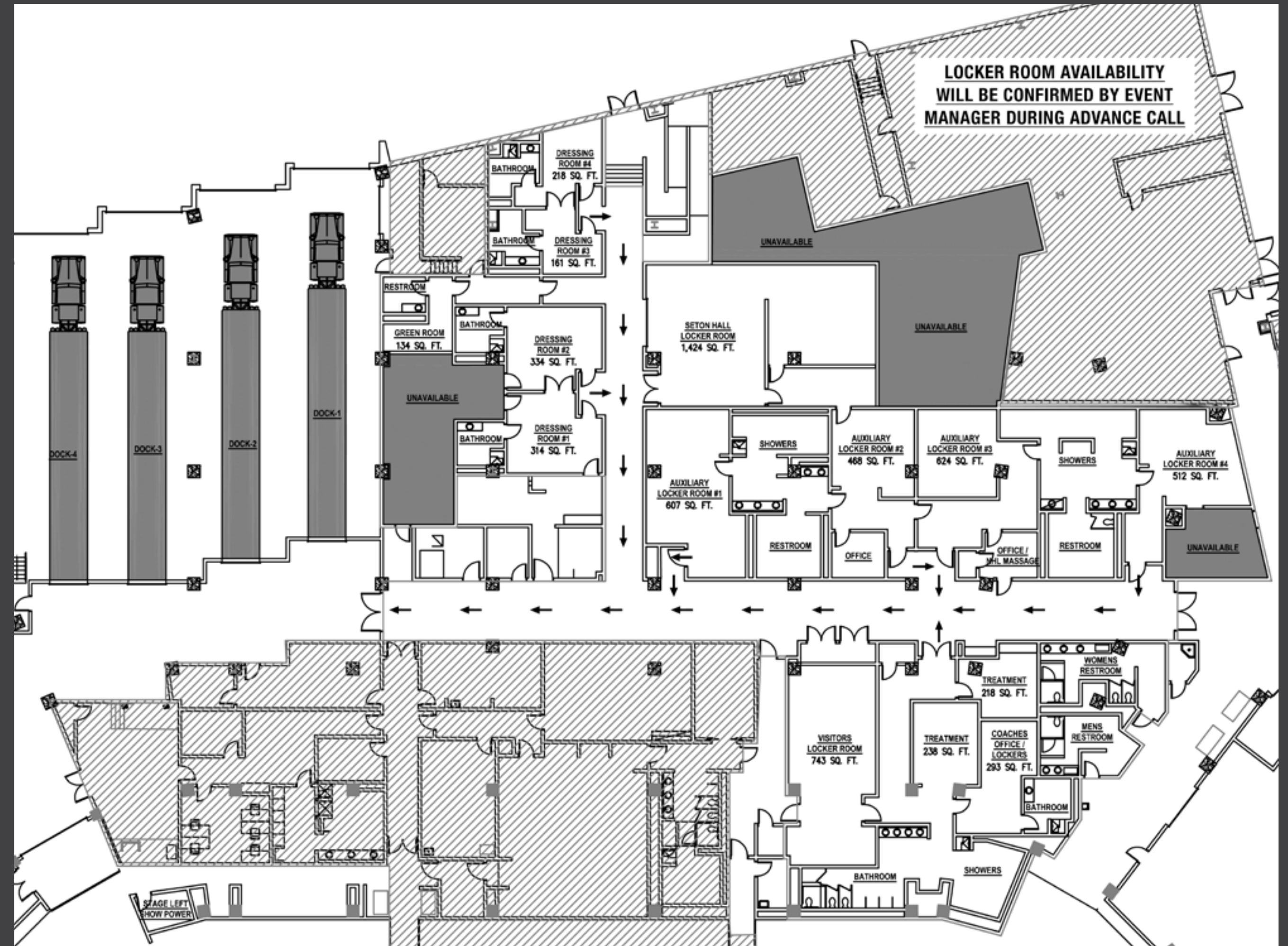

Technical

Press Media Room

Press Media Room is located stage right

Rooms (4)

- Press Media Room - main room is reserved for Tour Catering
- Digital Editing
- Radio Room
- Print Media

Please advance requests to utilize Digital Editing, Radio and Print Media with Event Manager

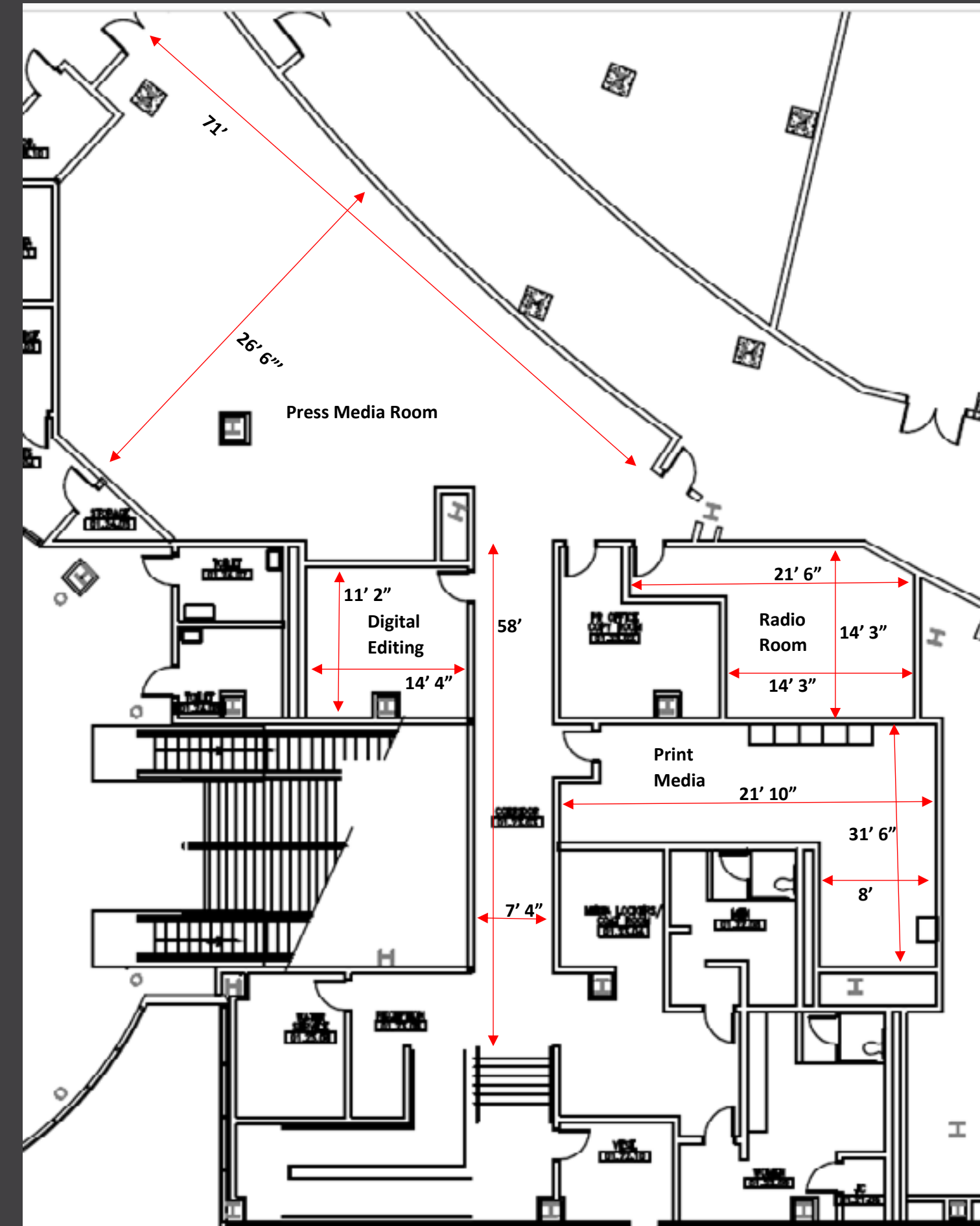

Hospitality

1982 Lounge

Availability of event space will be confirmed by event manager on advance call.



1982

Capacity: **150 Guests**

Catering Information

Please note: Caterers can only cook with convection ovens inside the building. No open flames are permitted.



Catering Entrance



Mulberry Street Pedestal
(if cooking outside)
One **200A/3 Phase; 208Y/120V**



Press Media Room
Prep tables can be provided by the venue,
at the discretion of the Event Manager.
One **100A/3 Phase; 208Y/120V**



Prep/Cooking Room
Comes equipped with a sink and ice chest.
Ice can be provided for an additional cost.
In the event that catering needs to expand to
the Prep Room, show must provide a minimum
of 150ft. of DOL cables with male cam locks.
One **80A/Single Phase; 208Y/120V**

Legends Hospitality is contractually obligated to provide Front of House catering

Technical

Rigging Information

- Rigging beams are located at the Catwalk Level, EL 108'-6" and are accessible from the Press Level.
- Rigging beams are continuous from the Center Stage to the End Stage and extend over a width of 120' between the queen posts.
- Center Stage has a total capacity of 150k lbs over the 4 center trusses, T1 & T2.
- End Stage has a total capacity of 200k lbs over the last 3 trusses, T3.1, T4.1, T5.1.
- Truss T3.2, opposite end stage has an additional capacity of 20 lbs for miscellaneous rigging.
- Building has a Fall Arrest System.



Technical

Show Power

Event Level Stage Right
(approximately 72 ft to center stage)

Four 400A; 208Y/120V

Two 200A; 208Y/120V

Max of **1600A** (shared with Service Level SR by Front of House)

Event Level Stage Right Front of House

One 400A; 208Y/120V

Event Level Stage Left

Four 400A; 208Y/120V

One 200A; 208Y/120V

Max of 1000A for Service Level Stage Left Power

Catwalk Level / Inner Catwalk

Four 200A; 208Y/120V Loading Dock

Eight 200A; 208Y/120V

Suppliers must bring cam locks for power connection

Show Power boxes take male cam locks

Staging

40' x 60' maximum with 12' x 24' sound wings adjustable from 48"-78"

Stage Right - Stage Barricade-100 feet

Crowd Control Barricade (Bike Rack) - 800 feet

Lighting

Event lights - Musco Shuttered

Work lights - Quartz

Follow spotlights
{8} Strong Gladiator IV 4.5KW

Please Confirm Availability with Event Manager In Advance
Gel Size - 13.5" Diameter

Theatrical - 20 Vari-light VL3000S

8 Martin 3000 Atomic Strobe

Speaker Info

Seating bowl loudspeaker system is based around 4 main clusters of high output loudspeakers mounted to hoist just above the outer perimeter of the center hung scoreboard assembly. Additional fill loudspeakers are used under the scoreboard and on the catwalk to supplement the main system. Power amplifiers will be connected to a centralized monitoring system in the audio control room. Horn type loudspeakers are mounted directly above the dashers to provide sound to seats where the main clusters are "shadowed" by the typical Plexiglas panels over the dasher boards.

Weight Restrictions: 4000lbs/deck

Main Floor restricted to **600 PSF**

Deck Size :4' x 8'

Washer

Water and drain—rabbit hole, unlimited number of connections off of hose line

Power—Standard quad and duplex (6 outlets)

Custodial mops are washed in in-house machines

Dryer

(2) 30 AMP circuits

Please note: Connections for washer and dryer must be USA connections only

Technical

Prudential Center Show Power Chart

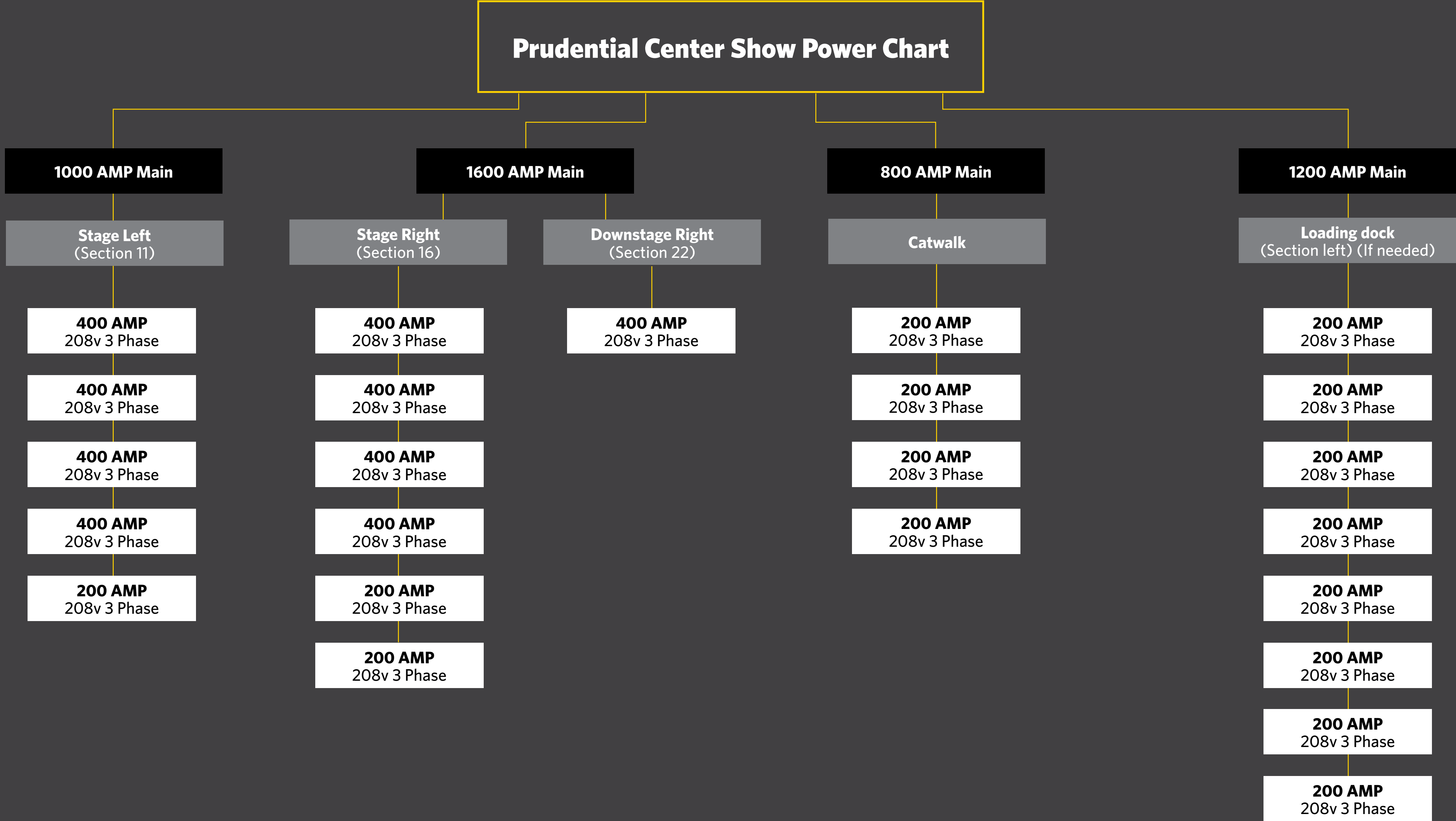

Technical

Com info

Building has hardwired ClearCom system as well as RTS wireless system. House personnel will be able to connect tour system to building system.

Press Room (Downstage Right)

- Total square footage is 2,169 sq ft that includes a dedicated print media area, radio media area, copy room, and coat room in addition to the main area that is dedicated to tour catering.
- Wireless Access available upon request.
- Direct access to Arena floor upstage-stage right and elevator to any level.
- Phone and fax available.
- Men's and Women's Restrooms.

Curtain System

The upper bowl blackout system has four motorized winch systems that control the North and South end, East and West side drapery. The North and South ends are broken into sections using chain motors for greater flexibility.

Half House Curtain System

- The half house system which goes from fascia to fascia is 80' high by 200' wide.

The use of both systems together will allow the facility to cut down the capacity from 17,500 seats to 4,000 seats.

Technical

Stagehand Minimums

Stagehand and Spotlight Operators: IATSE Local 21

Stage Build

- 4 Hours | If stage build occurs the same day as load-in the 4 hours for stage build will be ST and the first 4 hours of load-in, will be ST, then all will be OT.

Scope of Work

- Front of House, pipe and drape on or around the stage, and stage barricade are built by the stagehands, not building laborers

Load-In

- 8 Hour minimum (Loaders have a 6 hour minimum).
- Any load-in calls that start prior to 7am will be paid at time and a half from the time at which they start up until 7am.

Overtime

- Time and a half after 8 hours, never double time. (Double time only paid on holidays, see below for details)
- Must be fed a hot meal by the 5th hour or will receive meal penalty - extra hour at time and a half.
- Can do one hour walkaway for food and not get paid or remain on the clock and be fed a hot meal for 30 minutes while being paid. Pizza and/or soup does not constitute a hot meal

Show Call

- Separate rate from other calls. This is a separate call from load-in/load-out; the first 5 hours are ST regardless of what else has been worked that day. (If three show calls in one day at 4 hours each, they would all be ST hours)
- 4 hour minimum, after 5 hours is OT billed in half hour increments.
- If event is being broadcast live, stagehands receive a double show call.

Holidays

- First 8 hours are at time and a half, after 8 hours pay is double time.

Load-Out

- 4 hour minimum for those people who were on the load-in/show call that day.
- 5 hour minimum for those who did not work that day.

Work Call

- 4 hour minimum.

Premium Time

- Any hours worked prior to 7AM are billed at the overtime rate.

Load-In/Load-Out Rates

Position	Rate
Foreman	\$77.61
Assistant Foreman	\$71.82
Department Head	\$62.57
Head Rigger	\$71.82
Riggers	\$62.57
Loaders	\$45.73
Hands	\$49.95
Fork Op.	\$49.95
Wardrobe	\$49.95
House Electrician	\$91.78

Show Call Rates

Position	Rate
Foreman	\$77.61
Assistant Foreman	\$71.82
Department Head	\$64.89
Head Rigger	\$71.82
Loaders	\$47.76
Hands	\$52.15
Spotlight Operator (Sports)	\$53.26
Spotlight Operator	\$55.47
Spotlight Operator (Truss)	\$63.94
Fork Op.	\$52.15
Wardrobe	\$52.15
House Electrician	\$91.78

Expense rates as of 10/1/2021

Load-In Location with Main Floor Access

Load-In Information

- 4 Loading Docks available- **Bays 1-4**.
 - Loading Dock availability to be confirmed during advance with Event Manager
 - Ramp entrance (Bay 5) available.
- Loading dock is approximately 75' to arena floor.
- Load-in through backstage left 18'x20' elephant door into arena.
- Cargo Elevator 9' x 20' 15,000 pounds cap.
- Elephant Door - **16' h x 18' w** from outside.

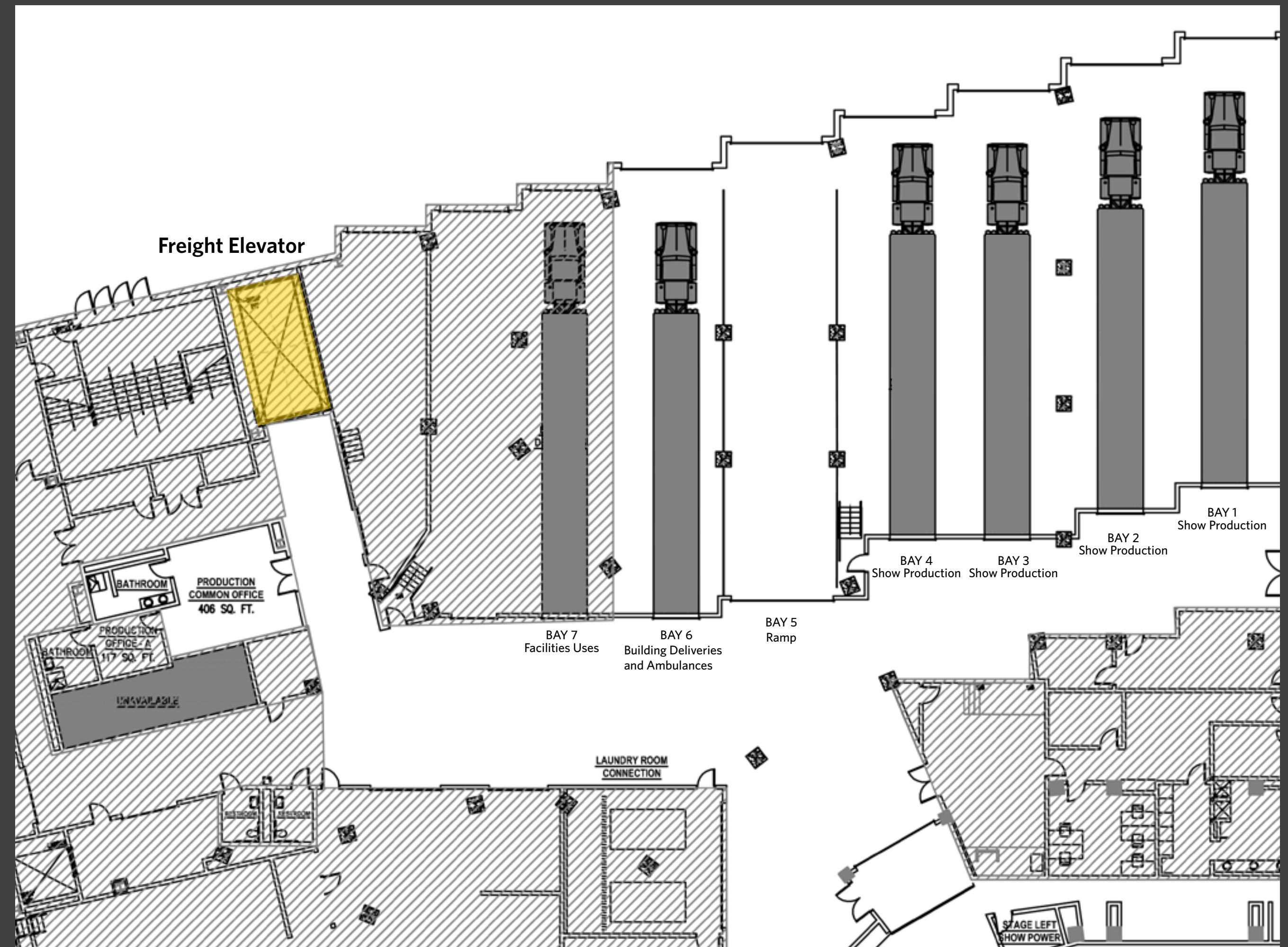

Information Technology

Dedicated IT Tech provided

Wi-Fi available for tour production

Hard line internet connection available upon request

Phone service available in dressing room/locker rooms upon request

Phone Numbers Available:

(973) 757-6870	(973) 757-6881
(973) 757-6871	(973) 757-6882
(973) 757-6872	(973) 757-6883
(973) 757-6873	(973) 757-6884
(973) 757-6874	(973) 757-6885
(973) 757-6875	(973) 757-6886
(973) 757-6876	(973) 757-6887
(973) 757-6877	(973) 757-6888
(973) 757-6878	(973) 757-6889
(973) 757-6879	(973) 757-6890

Additional Services

Box Office

- Address: 165 Mulberry Street Newark, NJ 07102
- Phone: (973) 757-6600
- Hours: 11AM-6PM *Subject to change based on building show schedule
- Ticket Seller labor provided for shows
- Ticketing Company : Ticketmaster

Guest Services

- Ticket Takers
- Ushers
- Supervisors

Security - provided by Securitas

- Additional backstage security as requested per act or promoter
- Entry screenings using magnetometers, wands, and bag searches

Custodial Services - provided by ABM

Medical Services - provided by RWJBarnabas Health

- Services provided for event attendees
- Ambulances
- Supervisors
- Paramedics
- Dedicated team for tour production available for an additional cost

Catering Services - provided by Legends Hospitality

- VIP Reception
- Front of House event spaces

Additional Services

In-House Production Needs

- Audio Services
- Staging
- Spotlights (2 fixed in Catwalk - house left and right, 6 portable)
- Forklifts (2)
- Floor Seating (Chairs)
- Flooring to cover the ice surface - provided by Athletica ArenaDeck
- 50' of banjo pipe and drape
- 8 - 6' x 30" tables
- 30 - 8' x 30" tables
- NOTE: Arena does not have an upstage black curtain. An Event Manager can assist with rental.

Building Utilities

- 2 commercial washers
- 2 commercial dryers
- Connection for washers/dryers supplied by tour available in stage-left VOM*
- Utilities including electricity, gas, lighting, water, heat, ventilation, air conditioning, hot and cold water, and waste removal services
 - In-house Electricians, HVAC, and mechanical plant stuff
- US standard electrical connections only
- *Please note, building housekeeping shares machines.

Services Available in Newark, NJ

- Hospital: The University Hospital
 - Address: 150 Bergen Street, Newark, NJ 07102
 - Phone: (973) 972-4300
- Urgent Care: CityMD
 - Address: 67 Broad Street, Newark, NJ 07102
 - Phone: (862) 246-7940
- Bus service to and from Prudential Center
- NJ Transit & Path Station located less than 3 blocks from the arena
- Uber pick-up and drop-off located on the corner of Mulberry Street and Edison Place outside of the Investors Bank Tower

**THANK YOU
FOR CHOOSING**



Prudential Center