



TECHNICAL PACKAGE

**200A LAKESHORE DRIVE
REGINA, SASKATCHEWAN
CANADA
S4S 7L3**

www.conexusartscentre.ca

CONEXUS ARTS CENTRE CAPITAL AUTO THEATRE

ADMINISTRATION STAFF

CHIEF EXECUTIVE OFFICER	Neil Donnelly	(306) 565-4500
THEATRE SERVICES MANAGER	Amanda Partridge amandap@conexusartscentre.ca	(306)565-4534
DIRECTOR OF CLIENT SERVICES	Shari Tourscher shari.tourscher@conexusartscentre.ca	(306-565-4516)
THEATRE SERVICES ASSISTANT	Emily Barton emilyb@conexusartscentre.ca	(306) 565-4504
BOX OFFICE COORDINATOR	Christine Hamilton boxoffice@conexusartscentre.ca	(306) 565-4500

TECHNICAL CONTACTS

HEAD STAGE CARPENTER	Gary Exner exner@conexusartscentre.ca	(306) 565-4529
HEAD AUDIO TECHNICIAN	Mitch Zaleschuk head.audio@conexusartscentre.ca	(306) 565-4531
HEAD LIGHTING TECHNICIAN	Riley Richter headlighting@conexusartscentre.ca	(306) 565-4537

RENTAL INFORMATION

Please contact Amanda Partridge amandap@conexusartscentre.ca directly for booking information and rates.

CATERING INFORMATION

The Conexus Arts Centre is a fully equipped Banquet and Convention facility. Please contact a Client Service Representative for more information at (306) 565-4500.

BOX OFFICE INFORMATION

The Conexus Arts Centre Box Office (CBO) uses ETIX computerized ticketing software. For more information please contact the Box Office directly at (306) 565-4500.

TECHNICAL INFORMATION

THEATRE SEATING: (Continental style - no center aisle) - Capacity 2031 seats

Main Level	1249 (includes 8 wheelchair)
	Using the Pit - 1157
1st Balcony	268
2nd Balcony	264
3rd Balcony	250

PROSCENIUM OPENING: Flex Proscenium (Moveable Sound Towers) 30'H X 55'W

FORESTAGE: U. S. Edge of Proscenium to D. S. Edge of Apron 6' 0"

WORKSTAGE:

U. S. Edge of Proscenium to back wall	53'9"
Width from Centre line to SR	85'8"
Width from Centre line to SL	85'8"
Overall Width of Stage	171'4"
Overall Depth of Stage	59'9"

WING SPACE:

S. L. - 38'W X 48'D
S. R. - 38'W X 26'D

STAGE DECK:

Stagelam Composite	
Over 1 1/2" edge grain spruce	
Sprung for dance	
Working load limit (average)	100 lbs/sq. in.

ORCHESTRA PIT:

Hydraulic Lift D. S. of apron	
Capacity	30,000 lbs
Travel Rate	8' / min
Dimensions:	
Width @ U.S. edge	53'
Width @ D.S. edge	65'6"
Depth	13'

ORCHESTRA SHELL:

Variable Depth and Height
4 Flown Ceiling Pieces
18 Rolling Towers
Approximate time required to set up – 1.5 hours

GENIE LIFT: In house 35' Genie Lift with rechargeable DC

RISERS: New Risers: 26 – 4x8', 8 – 4x6', 2 – 4' (various leg heights available 8" to 24")
Older Style: all 4' x 8' decks
Heights: 20 @ 8", 20 @ 16", 20 @ 24", 16 @ 32"

FLY SYSTEM: Double Purchase Counterweight
Lock rail located @ S.R. Gallery
Batten Length 75'
Batten Diameter 2 & 7/8ths "
Line Distance - 8" Centres

GRID HEIGHT: 92' Main Grid
65' Forestage Mini Grid (FOH LX points & Audio)

PIANOS: Performance Quality
2 - 9' Steinway Grand
1 - Yamaha U3 Upright
1 – Heintzman Baby Grand (Theatre Lobby)

MUSIC STANDS: Manhasset 30
Lights 30

TRUCK LOADING: Loading Area 27' X 38'
U. S. Right - Direct access to stage area
Dock level equal to Truck loading level
Capacity - 2 Truck Sealed Bays
Unlimited Bus and Truck Parking
No Parking Permits Required
Shore Power available upon request

STAGE POWER: Located Onstage
3-400 amp services 3 Phase (2 W/Camlock Located MSR)
2-200 amp services 3 Phase (W/Camlock, 1 MSR, 1 DSL)
4-50 amp services single phase (w/Stove Plug Located DSR, DSL, MSL, MSR)

LABOR: Stagehands/Wardrobe/Hair & Make Up Technicians
Supplied through IATSE Local #295
Yellow Card may be sent to Business Agent or Stage Carpenter at:
200A Lakeshore Drive
Regina, Saskatchewan
S4S 7L3

DRESSING ROOMS:

Stage Level:

6 rooms: 2 - 4 persons

All equipped with sink, toilet, shower, mirror & lights

Green Room

Comfortable setting for 20 - 30 persons

2nd Level:

2 Chorus Dressing Rooms: 20 - 30 persons

All equipped with sink, toilet, shower, mirror & lights

1 Dressing Room/Rehearsal Room: 20-30 persons

Equipped with sink, toilet, shower, mirror & lights,
Mirrors/Barre/Wood floor

REHEARSAL ROOM:

3rd Level

Mirrors/Barre/Wood floor (approximately 1456 sq ft)

Only available with prior written notice

WARDROBE:

2nd Level

2 irons & boards, steamer, 2 Washers & 3 Dryers

Conexus Arts Centre

CONEXUS ARTS CENTRE - AUDIO

CONTACT: MITCH ZALESCHUK – Head Audio Technician

House Mix Position - Permanent in booth on the main floor under the 1st balcony.

Tour Mix Position - Last 3 Rows of the Main Level Under the First Balcony - 20 seats per row

Rental costs apply to some audio equipment – contact us for a quote.

Touring Audio Power:

200 Amp/3 Phase W/Camlock Connection (Stage Left Downstage Wall)

Refer to Stage setup for other power specs.

HOUSE SPEAKER SYSTEM: (Rental costs apply)

12 Adamson S10 hi-mid cabinet per side

6 Adamson iS119 subwoofer per side

6 Adamson iS7p front fill

Lab Gruppen D120/D200 amplifiers, Lake processing

Tour patch available at FOH or DSL for LEFT, RIGHT, SUBS, FILLS using analog or Dante via Lake LM44

Centre Cluster (mono)

2 EAW LF SB118 subwoofer

4 EAW KF300 mid-hi

EAW MX300i Processor, QSC amplification

HOUSE CONSOLES:

Yamaha QL5 Permanently located in Audio Booth - **no remote I/O**

Yamaha M7CL-48

MONITORS:

5 Yamaha CM15V

2 QSC PLX2402 amplifiers

HOUSE DISTRIBUTED PROGRAM/PAGING SYSTEM

Backstage Paging System - combination of Toa and Bose, with individual volume control per dressing room.

HOUSE INTERCOM:

Wired Technical Projects Clear Com System

Patch points available DSL, DSR, MSL, MSR, USL, USR, Fly Rail, and Tour Mix Position

Permanent Posts located in Audio Booth, LX Booth, Spot Booth (x4), Fly Rail

12 Technical Projects Beltpack

12 Technical Projects Headset

MICROPHONES

9 Sennheiser e845
2 Sennheiser e845s
6 Shure SM 57
2 Shure SM58S
10 Shure SM58
1 Shure Beta 56
1 Sennheiser MD421
5 Sennheiser e604
1 Sennheiser e901
2 Sennheiser e609
2 Sennheiser e914
2 AKG 214
5 Rode NT-5
2 Crown PCC-160
1 Crown PZM-30PG
2 Neumann KM184

DI'S:

2 Radial Pro D2
4 Radial Pro D1
3 Radial JDI
1 Radial JDI Stereo
1 Whirlwind HotBox
4 ART AV Direct
4 Radial ProAV1

WIRELESS MICROPHONES

8 Sennheiser ew300G3 Receivers:
8 Sennheiser skm300G3 845 handheld
8 Sennheiser sk300 G3 belt packs
8 Apex 575 headset mics
1 Shure ULXD4Q-G50 *installed in audio booth
4 Shure ULXD1 Body pack
4 Shure ULXD2 handheld transmitter with SM58 capsule
5 Shure TH53 headsets (1 black, 4 beige)

OTHER EQUIPMENT:

EAW KF650/SB528 system consisting of 2 EAW SB528,
4 EAW KF650E with Xilica Processing, Yamaha PCN
Amplifiers

10 Yamaha DXR12/DXR12mkII
2 Yamaha DXS18XLF
2 Yamaha DSR118W
1 Yamaha MSR100 (Portable Powered Speaker)
2 Mackie SRM150

AV Equipment:

- 2 Panasonic ET-DLE085 short throw zoom lens
- 2 Da-Lite 38315 fast fold screen – 88"x140"
- 2 Panasonic PTRX870BU 8500 lumen projectors
- 2 PTZ Optics PT20X-NDI-ZCAM box camera
- 4 PTZ Optics 20X-NDI PTZ camera
- 1 PTZ Optics PTZ camera joystick/controller
- 1 Roland V160HD video switcher
- 1 Roland V1-SDI video switcher
- 2 Roland UVC-01 capture card
- 8 Blackmagic HDMI to SDI converter
- 8 Blackmagic SDI to HDMI converter
- 1 Blackmagic Designs ATEM Mini Pro ISO
- 1 Atomos Shinobi 7 monitor
- 2 ViewSonic 24" monitors

Conexus Arts Centre

CONEXUS ARTS CENTRE - LIGHTING

CONTACT: Riley Richter – Head Lighting Technician

Lighting Control Positions – permanent in windowed booth, or FOH Main Level under the First Balcony.

Rental costs apply to some Lighting equipment – contact us for a quote.

CAPITAL AUTO THEATRE

<u>Quantity</u>	<u>Make/Item</u>	<u>Notes</u>
1	ETC IonXe 20 console	FOH MAIN - 2 touchscreen monitor
1	ETC IonXe 20 console	BACKUP/SPARE - 1 touchscreen monitor
1	ETC Eos 40ch fader wing	
1	ETC remote tablet	
14	Colorsource 6' linear	Pit/Curtain warmer top
32	Martin Mac AuraXB wash	8 per line set (Bridge/#13/#26/#40)
18	Martin Mac Quantum profile	4 per line set (#13/#26/#40)
4	Elation Cuepix blinder WW4	Bridge
48	ETC Source4 15°-30° zoom	FOH and spot rail hang (750w)
48	ETC Source4 fixture body	Barrels - 2@10°/6@19°/18@26°/28@36°
18	Strand SL 23-50° zoom leko	
6	Strand SL 26° leko	
32	Strand Century 2321 leko	Rolling booms - 4 per boom
16	Cantata zoom leko	Rolling booms – 2 per boom
12	Cantata zoom leko	Box Booms
15	ETC Source4 par	Full lens set available
8	Ianiri Iris 4 1000w 3465 cyc light	Line set #61
8	Strand Orion 4005.200 3 unit ground row cyc	
2	Lycian M2 long throw 2500w follow spot	
2	Strong Supertrouper 2000w follow spot	C/W Telrad
2	LaMaitre Radiance hazer	DMX controllable
2	Ultratec Versa-Fan	DMX controllable

CONVENTION HALL

<u>Quantity</u>	<u>Make/Item</u>	<u>Notes</u>
1	ETC Smartfade console	
14	ETC Source4 par	Full lens kit available
6	ETC Source4 jr 25°-50° leko	
4	Strand Axial leko	

SHUMIATCHER THEATRE

Quantity	Make/Item	Notes
1	Johnson Controls 12ch. console	Mounted in rear wall of space
1	DMX-IN port for external console control	Located at FOH
6	Strand Axial leko 6x12	
9	Strand Axial leko 6x16	

THEATRE LOBBY

<u>Quantity</u>	<u>Make/Item</u>	<u>Notes</u>
1	ETC Colorsource20 console	Located in theatre booth
4	ETC ColorSource4 LED leko	2@26°/2@36°

PLEASE NOTE:

- House hang of main theatre automated fixtures may be removed but not relocated.
- Where possible, a LIGHTING PLOT would be appreciated in advance of arrival.
- All accessories, such as power distribution for band equipment, orchestra lights, offstage work light, some specials and most other incidental equipment is available.
- Please advise us of any special requirements in advance of the show arrival

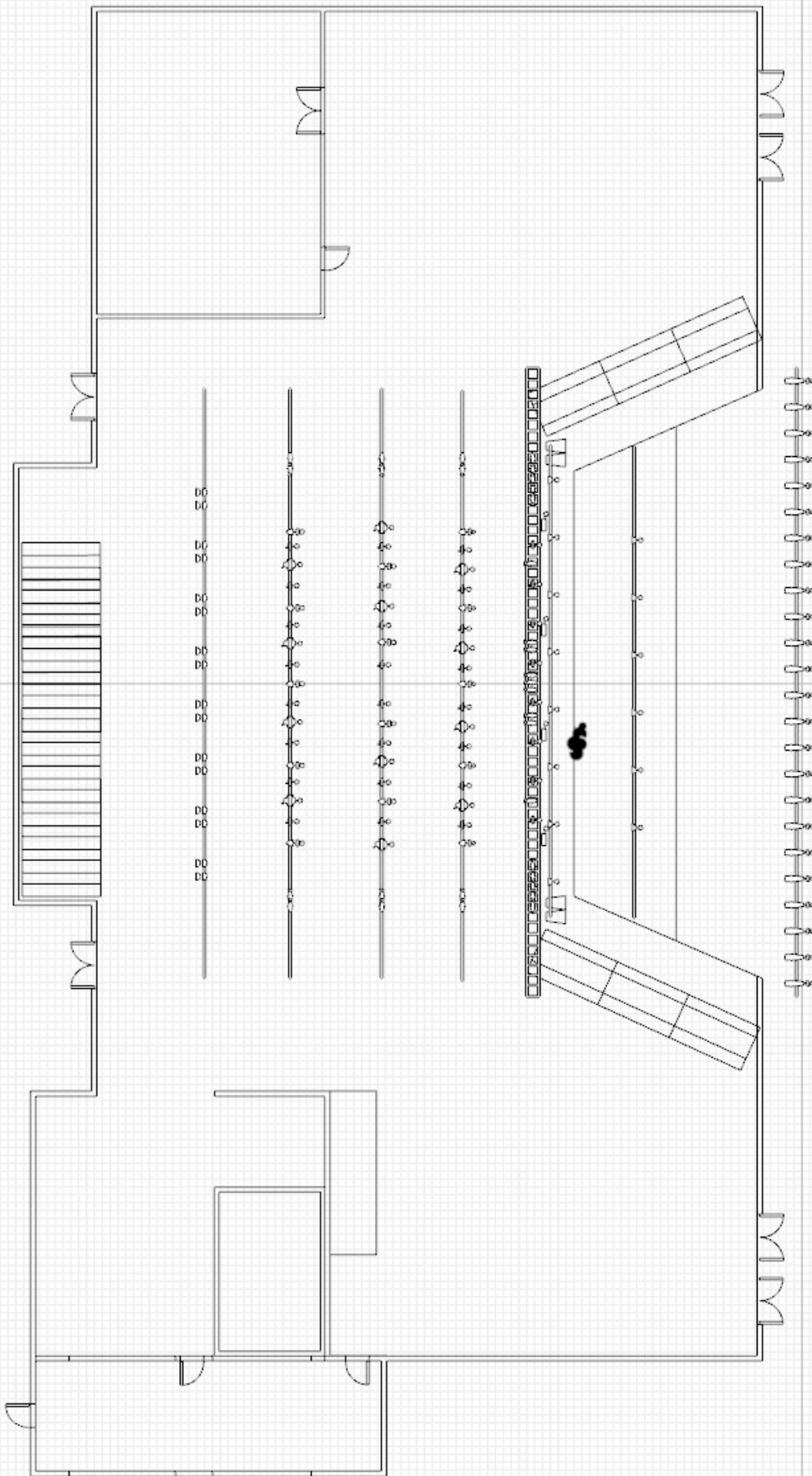

22 22 22 22 22 22 22 22 22 22 22 22

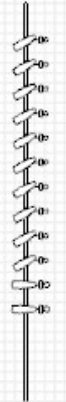

Conexus Arts Centre		Line Set Schedule		
Line Set #	Purpose	Distance	Arbor Size	NOTES
1	First Electrics	0 ft 0 in	LARGE	
2	Grand Valance	1 ft 0 in	SMALL	
3	Grand Drape	2 ft 0 in	LARGE	Very difficult pull when guillotine
4				Removed
5	Electrics Truss	3 ft 6 in	N/A	LX Bridge – weight limit over 2000 lbs
6	Leg # 1	4 ft 6 in	SMALL	adjustable opening on 20 foot track
7	Accoustical Baffle #1		N/A	Motor Assisted Orchestra Ceiling Baffle
8	Border #1	8 ft 3 in	SMALL	
9	Spare	9 ft 0 in	SMALL	
10	Spare	9 ft 7 in	SMALL	
11	Leg # 2	10 ft 3 in	MEDIUM	no track Currently
12	Spare	11 ft 0 in	SMALL	
13	Second Electrics	12 ft 0 in	X-LARGE	
14	Border # 2	13 ft 0 in	SMALL	
15	Spare	13 ft 6 in	SMALL	
16	1/4 Stage Traveller	14 ft 6 in	MEDIUM	used as extra leg / when not full black
17	Spare	15 ft 0 in	SMALL	
18	Spare	15 ft 6 in	SMALL	
19	Acoustical Baffle # 2		N/A	Motor Assisted Orchestra Ceiling Baffle
20	Spare	17 ft 9 in	SMALL	
21	Spare	18 ft 6 in	SMALL	
22	Border # 3	19 ft 3 in	SMALL	
23	Spare	20 ft 0 in	MEDIUM	
24	Leg # 3	20 ft 6 in	SMALL	adjustable opening on 20 foot track
25	Spare	21 ft 3 in	SMALL	
26	Third Electrics	22 ft 9 in	X-LARGE	
27	Border # 4	24 ft 0 in	SMALL	
28	Spare	24 ft 9 in	SMALL	
29	Mid - Stage Traveller	25 ft 6 in	LARGE	used as extra leg / when not full black
30	Spare	26 ft 3 in	SMALL	
31	Spare	27 ft 4 in	SMALL	
32	Spare	27 ft 11 in	SMALL	
33	Acoustical Baffle # 3		N/A	Motor Assisted Orchestra Ceiling Baffle

34	Spare	30 ft 0 in	SMALL	
35	Spare	30 ft 9 in	SMALL	
36	Border # 5	31 ft 6 in	SMALL	
37	Spare	32 ft 0 in	SMALL	
38	Leg # 4	32 ft 9 in	MEDIUM	adjustable opening on 20 foot track
39	Spare	33 ft 3 in	SMALL	
40	Fourth Electrics	34 ft 3 in	X-LARGE	
41	Spare	35 ft 3 in	SMALL	
42	Spare	35 ft 9 in	SMALL	
43	3/4 Stage Traveller	36 ft 6 in	MEDIUM	used as extra leg / when not full black
44	Spare	37 ft 3 in	SMALL	
45	Spare	38 ft 0 in	SMALL	
46	Acoustical Baffle # 4		N/A	Motor Assisted Orchestra Ceiling Baffle
47	Spare	41 ft 9 in	SMALL	
48	Border # 6	42 ft 6 in	SMALL	
49	Spare	43 ft 3 in	SMALL	
50	Spare	43 ft 9 in	SMALL	
51	Fifth Electrics	45 ft 0 in	X-LARGE	
52	Spare	46 ft 0 in	SMALL	
53	Spare	46 ft 6 in	SMALL	
54	Border # 7	47 ft 3 in	SMALL	
55	Up Stage Traveller	48 ft 0 in	MEDIUM	used as extra leg / when not full black
56	Spare	48 ft 9 in	SMALL	
57	Spare	49 ft 3 in	SMALL	
58	Spare	50 ft 0 in	SMALL	
59	Opera Folio	50 ft 9 in	SMALL	

****Please note pipe batten diameter is 2 & 7/8" rather than 2"**

If 2" is required please contact us in advance to make proper arrangements

Updated: January 2022

Batten Weight Restrictions

Small: 900 lbs

Medium: 1100 Lbs

Large: 1400 lbs (1 available, #29)

Extra Large: 1300 lbs